

## INSTALLATION INSTRUCTIONS

<b>S2262</b>		<b>6" 4-LINK SKEETER (2019-2022)</b>
1	FTS22221	6" 4-LINK SYSTEM BOX 1
1	SBT22261	6" 4-LINK SYSTEM BOX 2
1	SBT22262	6" REAR BOX KIT
1	SBT835233D	4.0 DIRT LOGIC SS (DRIVER)
1	SBT835233P	4.0 DIRT LOGIC SS (PASSENGER)
2	SBT811342	2.25 DLSS N/R
1	SBT22313	STEERING STABILIZER KIT

<b>S22623</b>		<b>6" 4-LINK SKEETER (2023)</b>
1	SBT222375	6" 4-LINK SYSTEM BOX 1
1	SBT22261	6" 4-LINK SYSTEM BOX 2
1	SBT22262	6" REAR BOX KIT
1	SBT835233D	4.0 DIRT LOGIC SS (DRIVER)
1	SBT835233P	4.0 DIRT LOGIC SS (PASSENGER)
2	SBT811342	2.25 DLSS N/R
1	SBT22313	STEERING STABILIZER KIT

## FORD SKEETER FIRE TRUCK

### 2019-2023 SUPERDUTY

### 6" 4-LINK SYSTEM

**FT22261i**

SBT22221 6" 4-LINK SYSTEM BOX 1		
2	FT30129BK	LOWER LINK
2	FT30692	UPPER LINK
2	FT30650	4-LINK POCKET

SBT22375 6" 4-LINK SYSTEM BOX 1 (2023 Models)		
2	FT31083	4-LINK POCKET
2	FT31084	UPPER LINK
2	FT31085	LOWER LINK
1	FT31088	HARDWARE KIT
2	FT31080	NUT TAB

FT31088 - HARDWARE KIT		LOCATION
4	3/4-10 X 5" HEX BOLT	4-LINK
16	3/4" SAE WASHER	
8	3/4-10 C-LOCK NUT	
4	3/4-10 X 1-1/2" HEX BOLT	4-LINK BRACKET
6	1/2-13 X 1-1/2" HEX BOLT	
10	1/2" SAE WASHER	
4	1/2-13 C-LOCK NUT	
2	1/2" SPLIT LOCK WASHER	
1	THREAD LOCKING COMPOUND 1 MIL	

SBT22261 6" 4-LINK SYSTEM BOX 2		
1	FT30903	PITMAN ARM
1	FT30988	TRACK BAR DROP BRACKET
1	FT30752	HARDWARE KIT
1	FT30751	HARDWARE SUBASSEMBLY
1	FT30958	SWAY BAR BRACKET (DRIVER)
1	FT30959	SWAY BAR BRACKET (PASS)
4	FT30960	CLEVIS
8	FT30961	MISALIGNMENT
2	FT30962	CENTER LINK
2	FT30963	HARDWARE KIT
2	FT90193	ROD END (RIGHT HAND)
2	FT90194	ROD END (LEFT HAND)

FT30751 HARDWARE SUBASSEMBLY		
1	FT22261i	INSTRUCTIONS
8	FT147	MISALIGNMENT
1	FT30258	SECTOR SHAFT NUT
2	FT30660	BRAKE LINE TAB
1	FT292	ALIGNMENT CAM KIT
1	FTAS12	STICKER FT BLUE 10X4 DIE CUT
1	FTREGCARD	REGISTRATION CARD

FT30752 - HARDWARE KIT		LOCATION
2	1/2-13 X 1-1/2" HEX BOLT	SWAY BAR (AXLE)
4	1/2 SAE WASHER	
2	1/2-13 C-LOCK NUT	
8	7/16 SAE WASHER G8 ZINC	SWAY BAR (FRAME)
4	7/16-14 C-LOCK NUT ZINC	
4	7/16-14 X 1 HEX HD	
2	3/8-16 X 1-1/4" HEX BOLT	BRAKE LINE
4	3/8" SAE WASHER	
2	3/8-16 NYLOCK NUT	
2	1/4 SAE WASHER	
1	1/4-20 GR C-LOCK NUT	
1	1/4-20 X 1 HEX BOLT G5 ZINC	
2	1/2-13 X 1-1/4 HEX BOLT	BUMP STOP
2	1/2-13 X 1-1/2 HEX BOLT	
6	1/2 SAE WASHER	
2	1/2-13 C-LOCK NUT	
4	3/4-10 X 1-1/2" HEX BOLT	4-LINK
4	3/4-10 X 5" HEX BOLT	
16	3/4 SAE WASHER	
8	3/4-10 C-LOCK NUT	
1	COTTER PIN	
1	THREAD LOCKING COMPOUND 1 MIL	
1	HOSE CLAMP	

FT30963 - HARDWARE KIT		LOCATION
2	1/2-13 X 2-3/4" HEX BOLT	SWAY BAR LINK
6	1/2 SAE WASHER	
4	1/2-13 C-LOCK NUT	
1	5/8-18 JAM NUT (RIGHT HAND)	
1	5/8-18 JAM NUT (LEFT HAND)	
1	THREAD LOCKING COMPOUND 1 MIL	

SBT22262 6" REAR BOX KIT		
4	FT766U	U-BOLT RD M18-1.4 X 21" X 3.17"
2	FTBK6	6" BLOCK
2	FT30476	SWAY BAR END LINK
2	FT30750	REAR BUMPSTOP
1	FT30753	HARDWARE SUBASSEMBLY

FT30753 HARDWARE SUBASSEMBLY		
8	FT1004	SWAY BAR LINK BUSHING
2	FT160	BLOCK SLEEVE
1	FT30754	HARDWARE KIT
1	FT50089	SWAY BAR LINK SLEEVE PACK

FT31133 - HARDWARE KIT		LOCATION
12	1/2 SAE WASHER	
6	1/2-13 NYLOCK NUT	
4	1/2-13 X 2-1/2" HEX BOLT	SWAY BAR
2	1/2-13 X 1-1/2" HEX BOLT	BUMPSTOP
8	M18 FLAT WASHER	
8	M18-1.5 NYLOCK NUT	
1	THREAD LOCKING COMPOUND 1 MIL	

## - TOOL LIST -

### *Required Tools (Not Included)*

- Basic Hand Tools
- Assorted Metric and S.A.E sockets, and Allen wrenches
- Torque Wrench
- Die Grinder w/ Cutoff Wheel or Sawzall
- 1-1/4" Hole Saw
- Basic Hand Tools
- Floor Jack
- Jack Stands
- Drill & assorted drill bits

## - PRE-INSTALLATION NOTES -

For technical assistance call: **909-597-7800** or e-mail: **info@fabtechmotorsports.com**

### *READ THIS BEFORE YOU BEGIN INSTALLATION -*

Check all parts to the parts list above before beginning installation. If any parts are missing contact Fabtech at 909-597-7800 and a replacement part will be sent to you immediately.

Read all instructions thoroughly from start to finish before beginning the installation. If these instructions are not properly followed severe frame, driveline and / or suspension damage may occur.

Check your local city and state laws prior to the installation of this system for legality. Do not install if not legal in your area.

Prior to the installation of this suspension system perform a front end alignment and record. Do not install this system if the vehicle alignment is not within factory specifications. Check for frame and suspension damage prior to installation.

The installation of this suspension system should be performed by two professional mechanics.

This suspension must be installed with Fabtech shock absorbers.

Use the provided thread locking compound on all hardware.

**WARNING-** Installation of this system will alter the center of gravity of the vehicle and may increase roll over as compared to stock.

Vehicles that receive oversized tires should check ball joints, uniballs, tie rods ends, pitman arm and idler arm every 2500-5000 miles for wear and replace as needed.

Verify differential fluid is at manufactures recommended level prior to kit installation. Installation of the kit will reposition the differential and the fill plug hole may be in a different position. (For example, if the manufacture recommends 3 quarts of fluid, make sure the diff has 3 quarts of fluid). Check your specific manual for correct amount of fluid.

### *Recommend Tires and Wheels:*

### *FOOTNOTES -*

# - INSTRUCTIONS -

## FRONT SUSPENSION

1. Disconnect the negative terminal on the battery. Jack up the front end of the truck and support the frame rails with jack stands. **NEVER WORK UNDER AN UNSUPPORTED VEHICLE!** Remove the front tires.
2. Disconnect the sway bar from the sway bar end links and frame. Remove sway bar from the vehicle. Save hardware. **SEE FIGURE 1**



FIGURE 1 - STEP 2

3. Disconnect the brake line from the frame and axle on both driver and passenger sides. Save hardware. **SEE FIGURES 2-3**

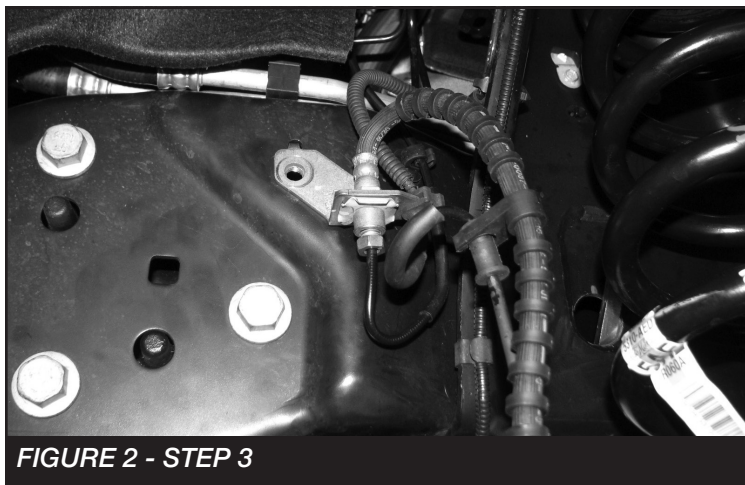

FIGURE 2 - STEP 3



FIGURE 3 - STEP 3

4. Remove the front shocks and discard, save hardware.
5. Lower the front axle allowing the coil springs to come free of tension and remove the coil springs. **EXERCISE EXTREME CAUTION WHEN WORKING WITH COIL SPRINGS UNDER LOAD!**
6. Disconnect the factory steering stabilizer from the frame mount. Remove the steering stabilizer frame bracket. Discard the frame bracket. Save all hardware.
7. Remove the drag link from the pitman arm. **Use care not to damage the threads on the drag link.**
8. Disconnect the trac bar from the frame bracket. Remove the trac bar bracket from the frame, save the original hardware and discard the factory trac bar bracket.
9. Remove the factory pitman arm from the steering box using a large pitman arm puller. Discard hardware and arm.
10. Install FT30903 (Pitman Arm) using the supplied FT30258 (Sector shaft nut). Torque to 350 ft-lbs. **NOTE: This is a one time only use nut. If remove, it must be discarded.**
11. Locate FT30988 (Track Bar Bracket). Attach to the frame using the original hardware in the same position. Torque bolts to 120 ft-lbs. **DO NOT ATTACH THE TRAC BAR TO THE FRAME BRACKET AT THIS TIME. SEE FIGURES 4-5**



FIGURE 4 - STEP 11

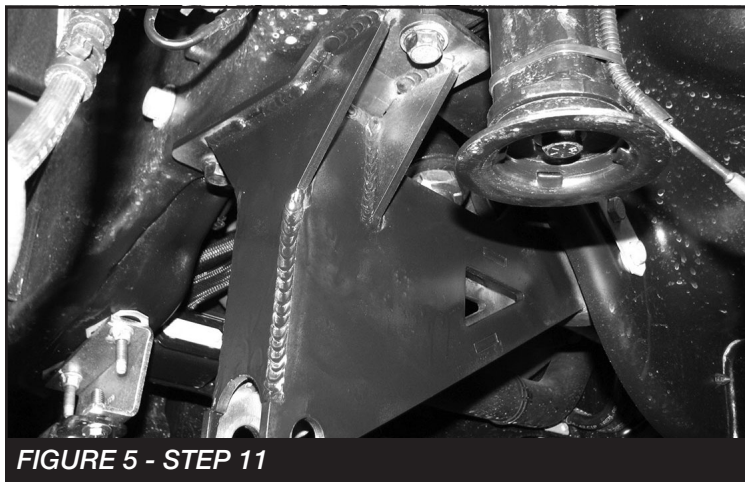

FIGURE 5 - STEP 11

12. With the front axle still supported by the floor jack, remove the Driver side factory radius arm.



## 2019-2022 Models Only

13. Locate FT30650 (4-Link pocket). Install the bracket into the factory radius arm pocket using the supplied  $\frac{3}{4}$ " x 1-1/2" bolts, nuts and washers through the original rear holes in the frame. Leave loose. **SEE FIGURE 6**

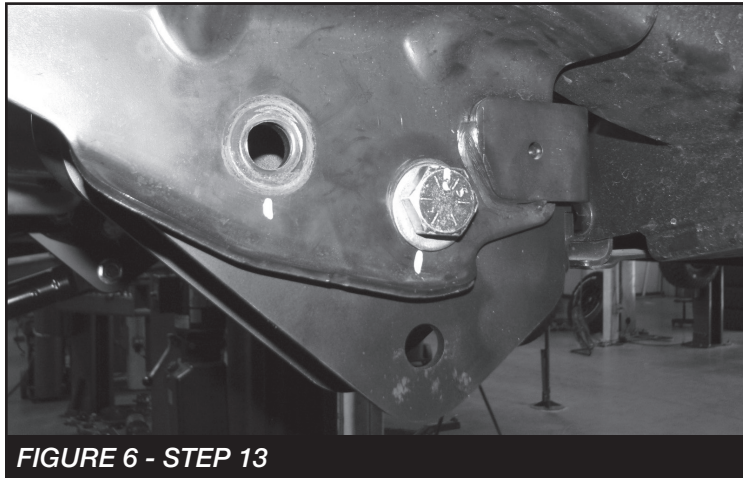

FIGURE 6 - STEP 13

14. Locate FT30129BK (Lower Link) and (2) FT147 (Misalignments). Install the link into the new bracket "lower hole" using the supplied  $\frac{3}{4}$ " X 5" Hardware. Install the FT292 (Alignment Cam kit) hardware at the axle side. Locate FT30692 (Upper Link) and (2) FT147 (Misalignments). Install the link into the new bracket forward upper hole" using the supplied  $\frac{3}{4}$ " X 5" Hardware. Use the factory hardware at the axle mount. Torque  $\frac{3}{4}$ " hardware to 380 ft-lbs, and factory axle bolts/alignment cams to 287 ft-lbs. **SEE FIGURES 7-8**

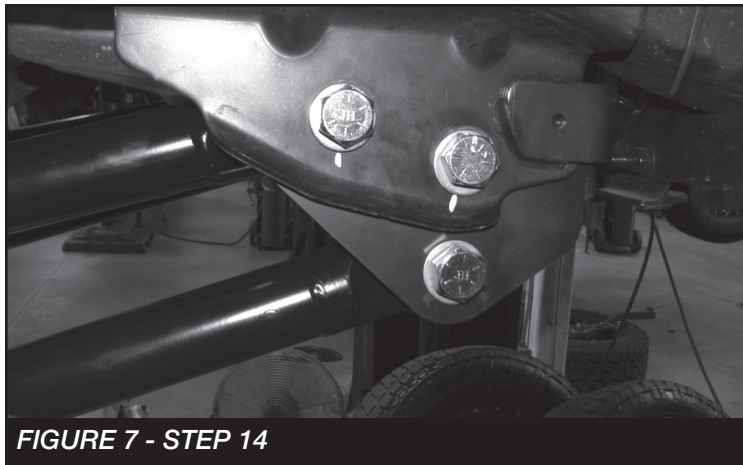

FIGURE 7 - STEP 14

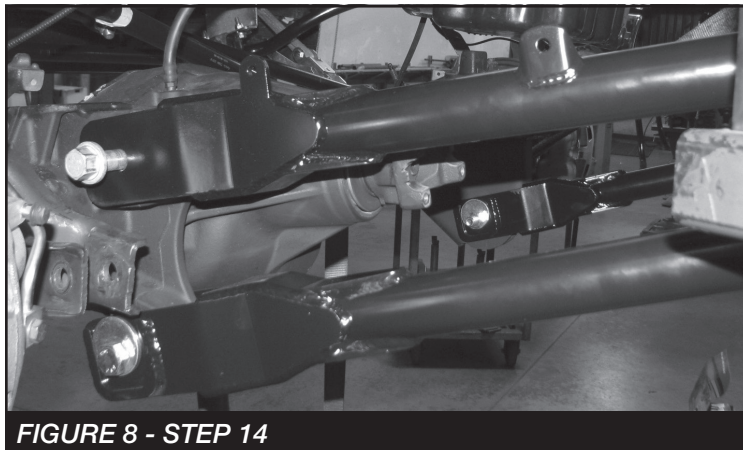

FIGURE 8 - STEP 14

## 2023 Models Only

15. Install FT31083 (4-Link Bracket) to the factory radius arm pocket using the supplied  $\frac{3}{4}$ " x 1-1/2" Bolts, washers and nuts and  $\frac{1}{2}$ " x 1-1/2" bolts, washers and nuts. **NOTE: Install on both the exterior and interior of the pocket. SEE FIGURE 9**

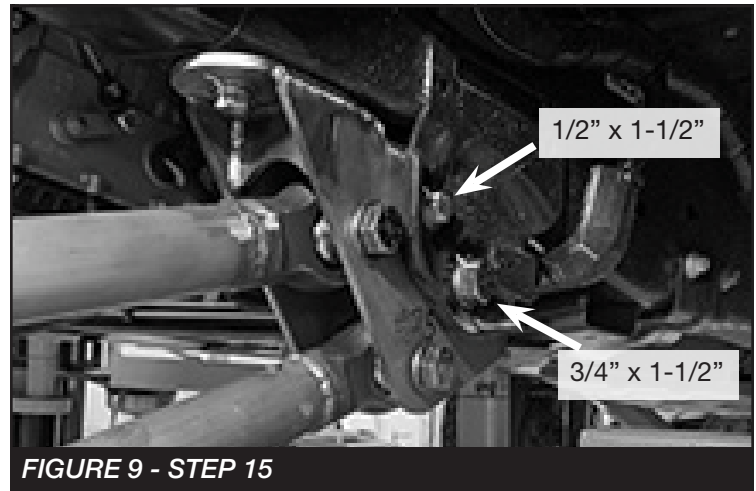

FIGURE 9 - STEP 15

16. Install the supplied FT31080 (Nut Tab) through the factory frame opening and install the  $\frac{1}{2}$ " x 1-1/2" bolt, washer and split washer to attach the new 4-link bracket to the frame. **SEE FIGURE 10.** Torque  $\frac{3}{4}$ " hardware to 380 ft-lbs and the  $\frac{1}{2}$ " hardware to 106 ft-lbs.

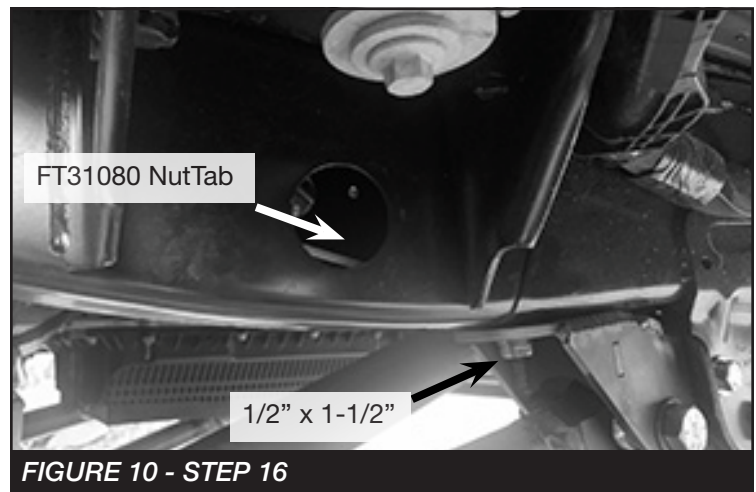

FIGURE 10 - STEP 16

17. Locate FT31085 (Lower Link) and (2) FT147 (Misalignments). Install the link into the new bracket "lower hole" using the supplied  $\frac{3}{4}$ " X 5" Hardware. Install the FT292 (Alignment Cam kit) hardware at the axle side. Locate FT31084 (Upper Link) and (2) FT147 (Misalignments). Install the link into the new bracket forward upper hole" using the supplied  $\frac{3}{4}$ " X 5" Hardware. Use the factory hardware at the axle mount. Torque  $\frac{3}{4}$ " hardware to 380 ft-lbs, and factory axle bolts/alignment cams to 287 ft-lbs. **SEE FIGURES 11-12**



FIGURE 11 - STEP 17

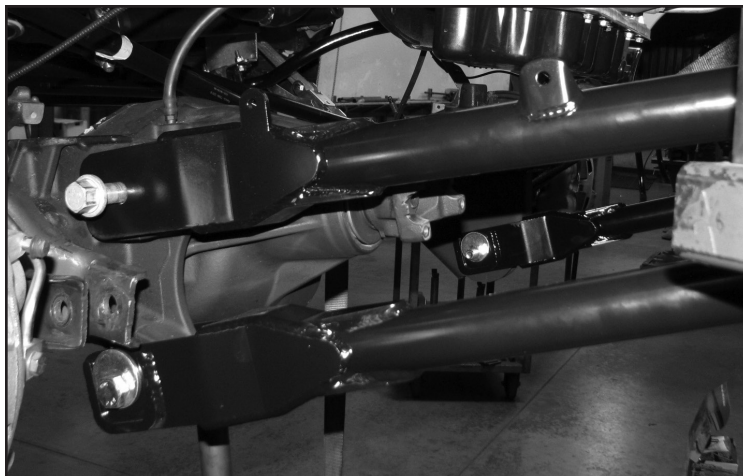

FIGURE 12 - STEP 17

- REPEAT STEPS ON PASSENGER SIDE
- IF INSTALLING A COILOVER CONVERSION KIT, DO SO NOW THEN SKIP TO STEP 20

18. Install FT30123BK (Coil Spring) using the factory upper isolator. **SEE FIGURE 13**



FIGURE 13 - STEP 18

19. Install the new front shocks FTS7188, FTS6188 or FTS810382 with the supplied bushing kits. Using the factory hardware. **NOTE: Install a supplied 9/16" washer at the lower mount to fill up the gap between the bushing and mount.** Due to vehicle variances the top of the lower shock mount may need to be sanded down to clear the shock body only if installing Stealth shocks. Torque the lower hardware to 111 ft-lbs and the upper to 46 ft-lbs.

20. Reinstall the track bar to the new frame bracket using the factory hardware. Torque to 300 ft-lbs. Install the drag link to the new Fabtech pitman arm using the factory hardware and the new supplied cotter pin. **NOTE: The drag link will need to be rotated 180 degrees and installed from the bottom side of the pitman arm. SEE FIGURE 14** Torque to 129 ft-lbs

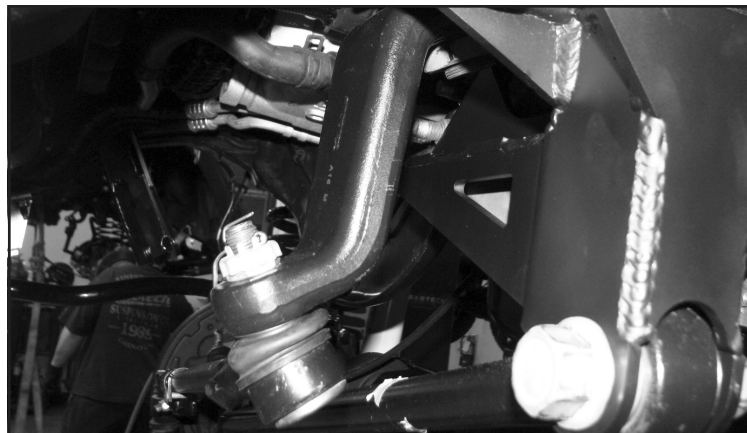

FIGURE 14 - STEP 20

21. **(DRIVER SIDE)** Install FT30660 (Brake line bracket) to the factory brake line tab using the supplied 3/8" hardware. Next, install the bracket to the frame using the factory hardware. Torque hardware to 37 ft-lbs. **SEE FIGURE 15**

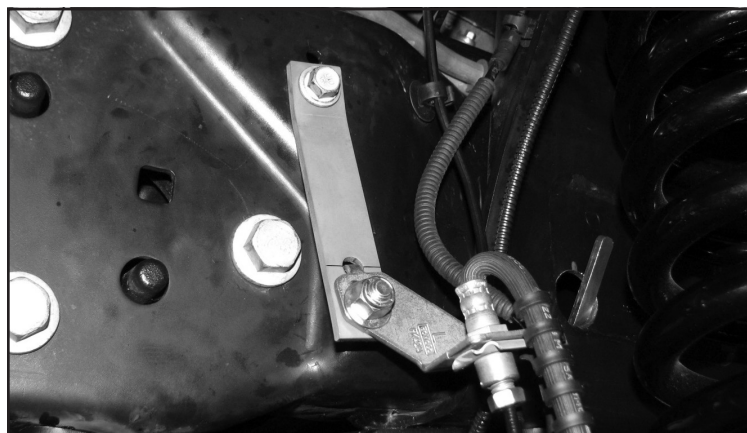
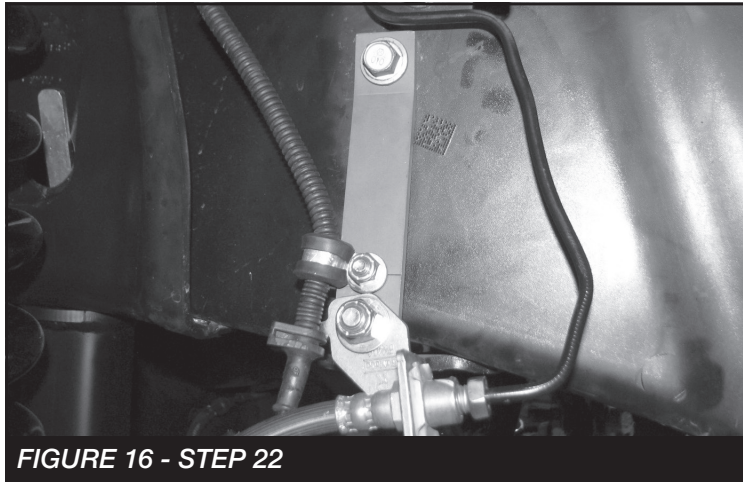

FIGURE 15 - STEP 21



22. **(PASSENGER SIDE)** Install FT30660 (Brake line bracket) to the factory brake line tab using the supplied 3/8" hardware (Use lower hole). Next, using the supplied rubber clamp and 1/4" hardware, attach the ABS line to the upper hole on the FT30660 bracket. Re attach to the frame using the factory hardware. Torque 3/8" & factory hardware to 37 ft-lbs. Torque 1/4" hardware to 14 ft-lbs. **SEE FIGURE 16**



23. Install FT30958 & FT30959 (Sway bar drop brackets) using the factory hardware. Reinstall the front sway bar to the new drop brackets using the supplied 7/16" hardware torque all hardware to 83 ft-lbs. **SEE FIGURE 17**

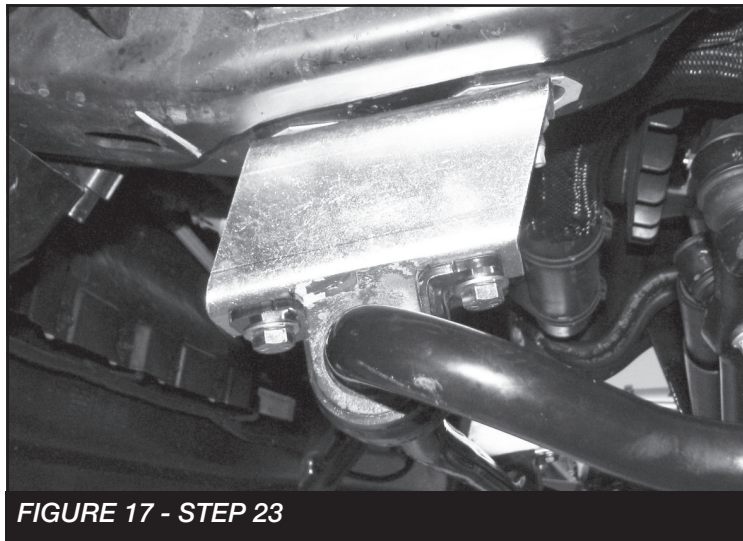

24. Locate FT90193 & FT90194 (Rod Ends) install the supplied 5/8" jam nuts. **NOTE: There are left and right hand threads.** Next, install the rod ends in to the FT30962 (Center Link). Using the supplied 1/2" x 2-3/4" bolts FT30961 (misalignments) and hardware, install the FT30960 (Clevis) to the rod ends. **SEE FIGURES 18-19**

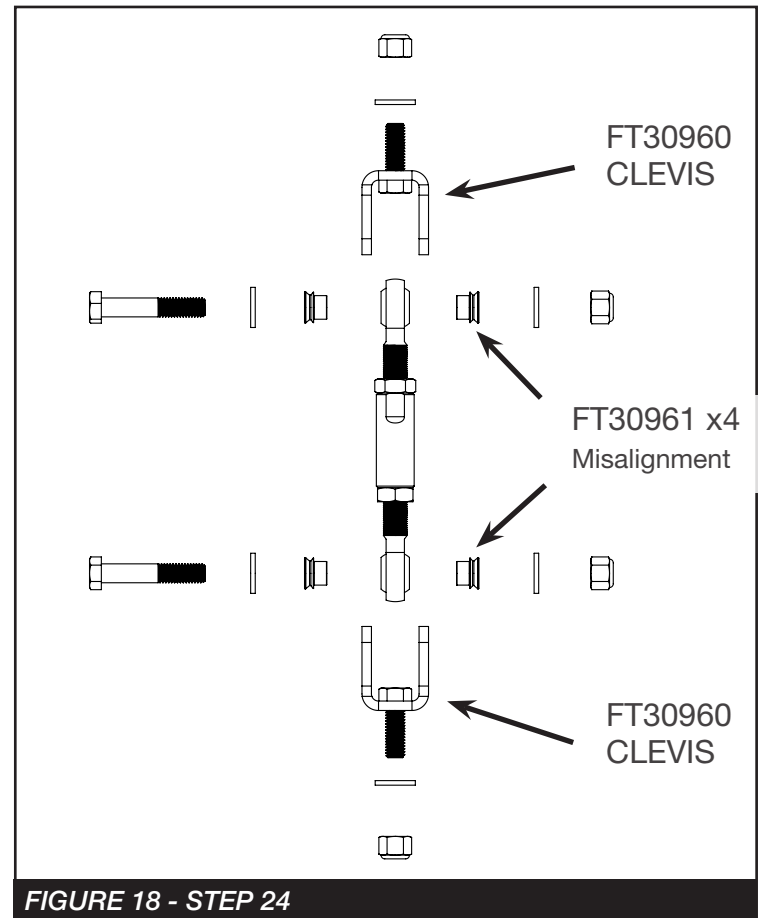

FIGURE 18 - STEP 24

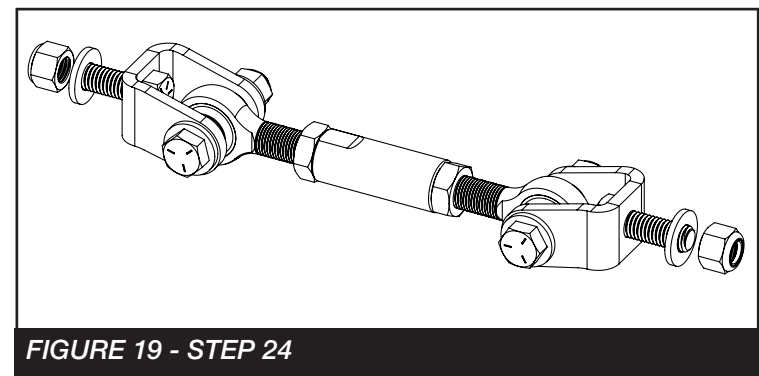

FIGURE 19 - STEP 24

25. Install the sway bar link assembly to the axle mount and the sway bar using the supplied 1/2" hardware.
26. Install the front tires and wheels. Torque lug nuts to wheel manufacturer's specifications.



## REAR SUSPENSION

27. Jack up the rear end. Remove the factory shocks, sway bar end links, bumpstops, ubolts and blocks.
28. Install FT30750 (Bumpstop Ext) to the factory bumpstop using the factory hardware. Then, install the assembly to the frame using the supplied 1/2" hardware. **SEE FIGURE 20**



29. Install the new FTBK6 (Blocks) using the supplied ubolts and hardware.
30. Assemble the rear sway bar links using FT30476 (Link), FT1004 (Bushings) & FT50089 (Sleeves). Install to the frame and sway bar using the supplied 1/2" x 2-1/2" hardware.
31. Install the new rear shocks SBT811342 using the factory hardware, torque the upper mount 46 ft-lbs. and the lower mount to 66 ft-lbs.
32. Install tires and wheels and torque lug nuts to wheel manufacturer's specifications. Turn front tires left to right and check for appropriate tire clearance. **Note - Some oversized tires may require trimming of the front bumper & valance.**
33. Check front end alignment and set to factory specifications. If the steering wheel needs to be straightened out do so by adjusting the drag link collar. Torque to 41 ft-lbs. Readjust headlights.
34. Recheck brake hoses, ABS wires and suspension parts for proper tire clearance while turning tires fully left to right.
35. Check the fluid in the front and rear differential and fill if needed with factory specification differential oil. **Note - some differentials may expel fluid after filling and driving. This can be normal in resetting the fluid level with the new position of the differential/s.**
36. Install Driver Warning Decal. Complete product registration card and mail to Fabtech in order to receive future safety and technical bulletins on this suspension.

**Vehicles that will receive oversized tires should check ball joints, uniballs and all steering components every 2500-5000 miles for wear and replace as required.**

**RE-TORQUE ALL NUTS, BOLTS AND LUGS AFTER 50 MILES AND PERIODICALLY THEREAFTER.**

For technical assistance call: **909-597-7800**

## - Product Warranty and Warnings -

Fabtech provides a Limited Lifetime Warranty to the original retail purchaser who owns the vehicle, on which the product was originally installed, for defects in workmanship and materials.

The Limited Lifetime Warranty excludes the following Fabtech items; bushings, bump stops, ball joints, tie rod ends, limiting straps, cross shafts, heim joints and driveshafts. These parts are subject to wear and are not considered defective when worn. They are warranted for 60 days from the date of purchase for defects in workmanship.

Dirt Logic and Performance Coilover take apart shocks are considered a serviceable shock with a one year warranty on leakage only. Service seal kits are available separately for future maintenance. All other shocks are covered under our Limited Lifetime Warranty.

Fabtech does not warrant any product for finish, alterations, modifications and/or installation contrary to Fabtech's instructions. Alterations to the finish of the parts including but not limited to painting, powder coating, plating and/or welding will void all warranties. Some finish damage may occur to parts during shipping, which is considered normal and is not covered under warranty.

Fabtech products are not designed nor intended to be installed on vehicles used in race applications or for racing purposes or for similar activities. (A "RACE" is defined as any contest between two or more vehicles, or any contest of one or more vehicle against the clock, whether or not such contest is for a prize). This warranty does not include coverage for police or taxi vehicles, race vehicles, or vehicles used for government or commercial purposes. Also excluded from this warranty are sales outside of the United States of America.

Installation of most suspension products will raise the center of gravity of the vehicle and will cause the vehicle to handle differently than stock. It may increase the vehicle's susceptibility to a rollover, on road and off road, at all speeds. Extreme care should be taken to operate the vehicle safely at all times to prevent rollover or loss of control resulting in serious injury or death. Fabtech front end Desert Guards may impair the deployment or operation of vehicles equipped with supplemental restraining systems/air bag systems and should not be installed if the vehicle is equipped as so.

Fabtech makes every effort to ensure suspension product compatibility with all vehicles listed on the website, but due to unknown auto manufacturer's production changes and/or inconsistencies by the auto manufacturer, Fabtech cannot be responsible for 100% compatibility, including the fitment of tire and wheel sizes listed. The Tire and Wheel sizes listed in Fabtech's website are only a guideline for street driving with noted fender trimming. Fabtech is not responsible for damages to the vehicle's body or tires. Fabtech is not responsible for premature wear of factory components due to the installation of oversized tires and wheels.

Fabtech's obligation under this warranty is limited to the repair or replacement, at Fabtech option, of the defective product only. All costs of removal, installation or re-installation, freight charges, incidental or consequential damages are expressly excluded from this warranty. Fabtech is not responsible for damages and/or warranty of other vehicle parts related or non related to the installed Fabtech product. This warranty is expressly in lieu of all other warranties expressed or implied. This warranty shall not apply to any product that has been subject to accident, negligence, alteration, abuse or misuse as determined by Fabtech.

Fabtech suspension components must be installed as a complete system including shocks as shown on our website. All warranties will become void if Fabtech parts are combined and/or substituted with other aftermarket suspension products. Combination and/or substitution of other aftermarket suspension parts may cause premature wear and/or product failure resulting in an accident causing injury or death. Fabtech does not warrant products not manufactured by Fabtech.

Depending on the condition of the factory suspension components retained after the installation of a Fabtech suspension not all vehicles may have the same ride stance front to rear as described in the website. The blue color of suspension components shown in all Fabtech photographs are for display purposes only. Majority of all Fabtech components will be black specifically where noted with part numbers ending in BK.

Installation of Fabtech product may void the vehicles factory warranty; it is the consumer's responsibility to check with their local vehicle's dealer for warranty disposition before the installation of the product. Some state laws may prohibit modification of suspension to a vehicle in whole or in part. It is the responsibility of the installer and consumer to consult local laws prior to the installation of any Fabtech suspension product to comply with such written laws.

It is the responsibility of the distributor and/or the retailer to review all warranties and warnings of Fabtech products with the consumer prior to purchase.

Fabtech reserves the right to super cede, discontinue, change the design, finish, part number and/or application of parts when deemed necessary without written notice. Fabtech is not responsible for misprints or typographical errors within the website or price sheet. For the most recent Product Warranty and Warnings visit our website [www.fabtechmotorsports.com](http://www.fabtechmotorsports.com)