



INSTALLATION INSTRUCTIONS

2007-2018 JEEP WRANGLER HI CLEARANCE STEERING STABILIZER FT24112i

Fabtech Motorsports | 4331 Eucalyptus Ave. Chino, CA 91710

Tech Line: 909-597-7800 | **Fax:** 909-597-7185 | **Web:** www.fabtechmotorsports.com

- PARTS LIST -

FTS24112 HI CLEAR STABILIZER BRACKET KIT		
1	FT50486BK	STABILIZER BRACKET
1	FT50457	HARDWARE SUBASSEMBLY

FTS24168 HI CLEAR STABILIZER KIT W/STEALTH		
1	FT50486BK	STABILIZER BRACKET
1	FT50460	HARDWARE SUBASSEMBLY
1	FTS6610	STEALTH STEERING STABILIZER

FT50457 HARDWARE SUBASSEMBLY		
1	56120004152	9/16-12 C-LOCK NUT
2	56000005081	9/16" SAE WASHER
1	56123251081	9/16-12 X 3-1/4" HEX BOLT
1	37161001081	3/8-16 X 1" HEX BOLT
1	37160004152	3/8-16 C-LOCK NUT
2	37000005052	3/8 SAE WASHER
1	FTLOCK	THREAD LOCKING COMPOUND
1	FT24112i	INSTRUCTIONS
1	FTAS12	STICKER FT BLUE 10X4 DIE CUT
1	FTAS16	DRIVER WARNING DECAL
1	FTREGCARD	REGISTRATION CARD

FT50460 HARDWARE SUBASSEMBLY		
1	56120004152	9/16-12 C-LOCK NUT
2	56000005081	9/16" SAE WASHER
1	56123251081	9/16-12 X 3-1/4" HEX BOLT
1	37161001081	3/8-16 X 1" HEX BOLT
1	37160004152	3/8-16 C-LOCK NUT
2	37160004152	3/8 SAE WASHER
1	50130004152	1/2-13 C-LOCK NUT
2	50000005081	1/2" SAE WASHER
1	50132501081	1/2-13 X 2-1/2 HEX BOLT
1	FTLOCK	THREAD LOCKING COMPOUND
1	FT24112i	INSTRUCTIONS
1	FTAS12	STICKER FT BLUE 10X4 DIE CUT
1	FTAS16	DRIVER WARNING DECAL
1	FTREGCARD	REGISTRATION CARD

FTS24169 HI CLEAR STABILIZER KIT W/DLSS		
1	FT50486BK	STABILIZER BRACKET
1	FT50465	HARDWARE SUBASSEMBLY
1	FT850051-U	DLSS 2.0 STEERING STABILIZER

FT50465 HARDWARE SUBASSEMBLY		
1	FT50544	HARDWARE KIT
3	FT83172	SPACER
1	FT83173	SPACER
1	FT24112i	INSTRUCTIONS
1	FTAS12	STICKER FT BLUE 10X4 DIE CUT
1	FTAS16	DRIVER WARNING DECAL
1	FTREGCARD	REGISTRATION CARD

FT50544 - HARDWARE KIT		LOCATION
2	M12 SAE WASHER	
1	M12-1.75 X 60MM HEX BOLT	
1	M12-1.75 C-LOCK	
1	9/16-12 C-LOCK	
2	9/16" SAE WASHER	
1	9/16-12 X 3-1/4" HEX BOLT	
1	3/8-16 X 1" HEX BOLT	
2	3/8 SAE WASHER	
1	3/8-16 C-LOCK NUT	
1	THREAD LOCKING COMPOUND	



- TOOL LIST -

Required Tools (Not Included)

Basic Hand Tools
Assorted Metric and S.A.E sockets, and Allen wrenches
Torque Wrench

- PRE-INSTALLATION NOTES -

For technical assistance call: **909-597-7800** or e-mail: **info@fabtechmotorsports.com**

READ THIS BEFORE YOU BEGIN INSTALLATION -

Check all parts to the parts list above before beginning installation. If any parts are missing contact Fabtech at 909-597-7800 and a replacement part will be sent to you immediately.

Read all instructions thoroughly from start to finish before beginning the installation. If these instructions are not properly followed severe frame, driveline and / or suspension damage may occur.

Check your local city and state laws prior to the installation of this system for legality. Do not install if not legal in your area.

Prior to the installation of this suspension system perform a front end alignment and record. Do not install this system if the vehicle alignment is not within factory specifications. Check for frame and suspension damage prior to installation.

The installation of this suspension system should be performed by two professional mechanics.

This suspension must be installed with Fabtech shock absorbers.

Use the provided thread locking compound on all hardware.

WARNING- Installation of this system will alter the center of gravity of the vehicle and may increase roll over as compared to stock.

Vehicles that receive oversized tires should check ball joints, uniballs, tie rods ends, pitman arm and idler arm every 2500-5000 miles for wear and replace as needed.

Verify differential fluid is at manufactures recommended level prior to kit installation. Installation of the kit will reposition the differential and the fill plug hole may be in a different position. (For example, if the manufacture recommends 3 quarts of fluid, make sure the diff has 3 quarts of fluid). Check your specific manual for correct amount of fluid.

FOOTNOTES

- INSTRUCTIONS -

1. Remove the factory stabilizer from the axle. Save hardware.
2. **NOTE: If installing with a Fabtech track bar bracket skip to step 5.**
3. Disconnect the factory track bar from the axle.
4. Install the bracket using the supplied 9/16" and 3/8" hardware. Torque 9/16" hardware to 184 ft-lbs and 3/8" hardware to 52 ft-lbs. **SEE FIGURE 1**

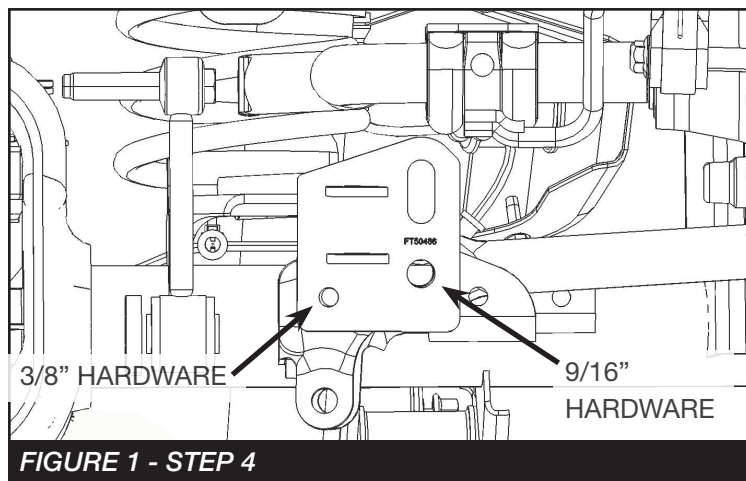

5. Disconnect the factory track bar from the track bar bracket. Next, remove the bolt attaching the Fabtech bracket to the factory axle bracket. Save hardware.
6. Install the FT50486BK (Stabilizer bracket) using the supplied 3/8" and 9/16" hardware removed from the previous step. Torque 9/16" hardware to 184 ft-lbs and 3/8" hardware to 52 ft-lbs. Next, reinstall the track bar with the supplied 9/16" hardware. Torque to 184 ft-lbs. **SEE FIGURE 2**

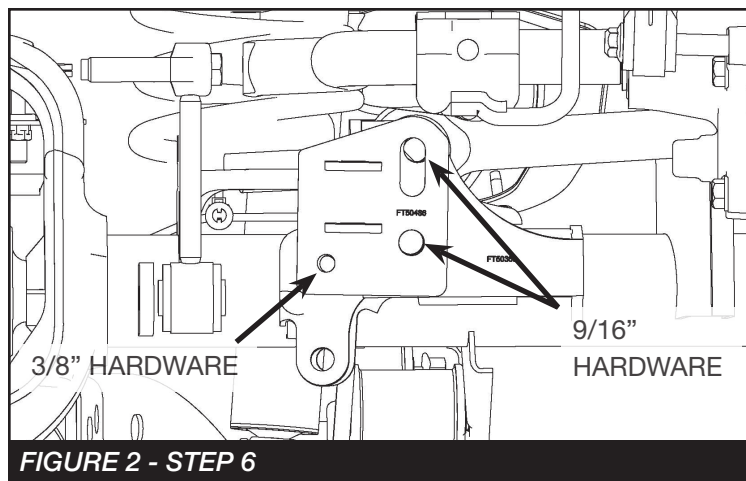

7. Locate the factory stabilizer mount on the center link. Loosen and rotate up like shown in **FIGURE 3**



8. If reinstalling the factory stabilizer do so with the factory hardware.
9. If installing with FTS6610 (Stealth stabilizer). Install with the body of the stabilizer toward the inside of the vehicle with the supplied 1/2" hardware. Torque to 127 ft-lbs.
10. If installing FT850051-U (Dirt Logic Stabilizer), locate the misalignment spacers. Install the larger spacer on the body side lower so it spaces away from the tie rod. Insert the other 3 spacers and install with the supplied 12mm hardware. Torque to 100 ft-lbs. **SEE FIGURE 4**

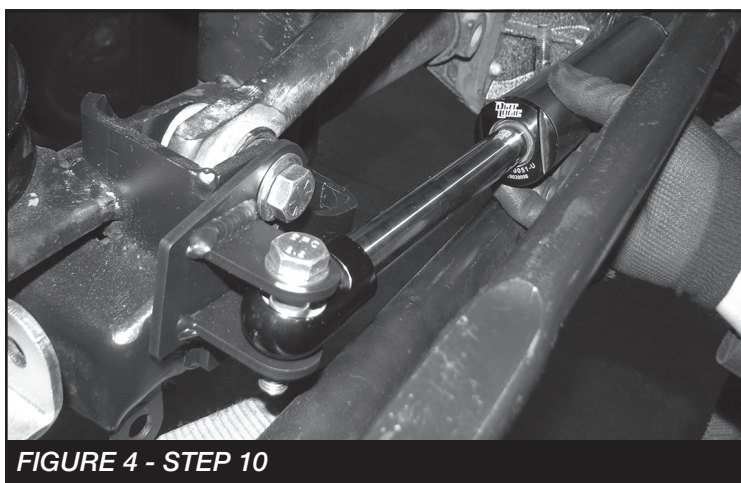

11. Cycle the steering left and right at full lock to check for clearance. make adjustments if needed.
12. Recheck all bolts for proper torque.
13. Install Driver Warning Decal. Complete product registration card and mail to Fabtech in order to receive future safety and technical bulletins on this suspension.

Vehicles that will receive oversized tires should check ball joints, uniballs and all steering components every 2500-5000 miles for wear and replace as required.

**RE-TORQUE ALL NUTS, BOLTS AND LUGS
AFTER 50 MILES AND PERIODICALLY
THEREAFTER.**

For technical assistance call: **909-597-7800**

- Product Warranty and Warnings -

Fabtech provides a Limited Lifetime Warranty to the original retail purchaser who owns the vehicle, on which the product was originally installed, for defects in workmanship and materials.

The Limited Lifetime Warranty excludes the following Fabtech items; bushings, bump stops, ball joints, tie rod ends, limiting straps, cross shafts, heim joints and driveshafts. These parts are subject to wear and are not considered defective when worn. They are warranted for 60 days from the date of purchase for defects in workmanship.

Dirt Logic and Performance Coilover take apart shocks are considered a serviceable shock with a one year warranty on leakage only. Service seal kits are available separately for future maintenance. All other shocks are covered under our Limited Lifetime Warranty.

Fabtech does not warrant any product for finish, alterations, modifications and/or installation contrary to Fabtech's instructions. Alterations to the finish of the parts including but not limited to painting, powder coating, plating and/or welding will void all warranties. Some finish damage may occur to parts during shipping, which is considered normal and is not covered under warranty.

Fabtech products are not designed nor intended to be installed on vehicles used in race applications or for racing purposes or for similar activities. (A "RACE" is defined as any contest between two or more vehicles, or any contest of one or more vehicle against the clock, whether or not such contest is for a prize). This warranty does not include coverage for police or taxi vehicles, race vehicles, or vehicles used for government or commercial purposes. Also excluded from this warranty are sales outside of the United States of America.

Installation of most suspension products will raise the center of gravity of the vehicle and will cause the vehicle to handle differently than stock. It may increase the vehicle's susceptibility to a rollover, on road and off road, at all speeds. Extreme care should be taken to operate the vehicle safely at all times to prevent rollover or loss of control resulting in serious injury or death. Fabtech front end Desert Guards may impair the deployment or operation of vehicles equipped with supplemental restraining systems/air bag systems and should not be installed if the vehicle is equipped as so.

Fabtech makes every effort to ensure suspension product compatibility with all vehicles listed on the website, but due to unknown auto manufacturer's production changes and/or inconsistencies by the auto manufacturer, Fabtech cannot be responsible for 100% compatibility, including the fitment of tire and wheel sizes listed. The Tire and Wheel sizes listed in Fabtech's website are only a guideline for street driving with noted fender trimming. Fabtech is not responsible for damages to the vehicle's body or tires. Fabtech is not responsible for premature wear of factory components due to the installation of oversized tires and wheels.

Fabtech's obligation under this warranty is limited to the repair or replacement, at Fabtech option, of the defective product only. All costs of removal, installation or re-installation, freight charges, incidental or consequential damages are expressly excluded from this warranty. Fabtech is not responsible for damages and/or warranty of other vehicle parts related or non related to the installed Fabtech product. This warranty is expressly in lieu of all other warranties expressed or implied. This warranty shall not apply to any product that has been subject to accident, negligence, alteration, abuse or misuse as determined by Fabtech.

Fabtech suspension components must be installed as a complete system including shocks as shown on our website. All warranties will become void if Fabtech parts are combined and/or substituted with other aftermarket suspension products. Combination and/or substitution of other aftermarket suspension parts may cause premature wear and/or product failure resulting in an accident causing injury or death. Fabtech does not warrant products not manufactured by Fabtech.

Depending on the condition of the factory suspension components retained after the installation of a Fabtech suspension not all vehicles may have the same ride stance front to rear as described in the website. The blue color of suspension components shown in all Fabtech photographs are for display purposes only. Majority of all Fabtech components will be black specifically where noted with part numbers ending in BK.

Installation of Fabtech product may void the vehicles factory warranty; it is the consumer's responsibility to check with their local vehicle's dealer for warranty disposition before the installation of the product. Some state laws may prohibit modification of suspension to a vehicle in whole or in part. It is the responsibility of the installer and consumer to consult local laws prior to the installation of any Fabtech suspension product to comply with such written laws.

It is the responsibility of the distributor and/or the retailer to review all warranties and warnings of Fabtech products with the consumer prior to purchase.

Fabtech reserves the right to super cede, discontinue, change the design, finish, part number and/or application of parts when deemed necessary without written notice. Fabtech is not responsible for misprints or typographical errors within the website or price sheet. For the most recent Product Warranty and Warnings visit our website www.fabtechmotorsports.com