



www.fabtechmotorsports.com

**4331 EUCALYPTUS AVE. CHINO, CA. 91710
PHONE 909-597-7800 FAX 909-597-7185**

**FTS26011
Dual Steering Stabilizer System
2005 - 2008 Toyota Tacoma 4WD & 6 LUG 2WD W/O VSC KIT
WITH FABTECH 6 INCH KIT**

PARTS LIST:

Qua	Part #	Description
2	FT70076	Tie Rod Bracket
1	FT70077	Driver Frame Bracket
1	FT70078	Pass. Frame Bracket
2	FTS7009	Stabilizer
4	FTS31UBK	U-Bolt Kit
1	FT70079	Hardware Kit
1	FTAS12	Sticker
1	FTREGCARD	Reg Card
2	FT96000i	Instruction Sheet

HARDWARE LIST:

Qua	Description	Location
2	1/2"-13 x 4 1/4" Hex Cap Bolt	Shock @ Frame Bracket
2	1/2"-13 C-Lock Nuts	
2	1/2" SAE Flat Washers	
4	1/2" USS Flat Washers	
2	1/2"-13 x 2 3/4" Hex Cap Bolt	Shock @ Tie Rod Bracket
2	1/2"-13 C-Lock Nuts	
4	1/2" SAE Flat Washers	
4	1/2"-13 x 1 1/4" Hex Cap Bolt	Frame Bracket to Frame
4	1/2"-13 C-Lock Nuts	
8	1/2" SAE Flat Washers	

Tool List: (Not Included)

- Assorted Metric and S.A.E Sockets & Box Wrenches
- Die Grinder with Carbide Bit
- Measuring Tape
- Paint Pen or Marker

READ ALL INSTRUCTIONS THOROUGHLY FROM START TO FINISH BEFORE BEGINNING INSTALLATION!

THIS STEERING STABILIZER SYSTEM WILL NOT WORK WITH THE O.E.M. WHEELS. A 17 X 8 WHEEL WITH A BACK SPACING OF 4 5/8" MUST BE USED.

CHECK ALL PARTS INCLUDED IN THIS KIT TO THE PARTS LIST ABOVE BEFORE BEGINNING INSTALLATION OF THIS KIT. IF ANY PIECES ARE MISSING, CONTACT FABTECH AT 909-597-7800.

INSTRUCTIONS:

1. Disconnect the negative terminal on the battery. Park the truck on level ground and set the emergency brake. Jack up the front end of the truck and support the frame, at the front frame rails, with jack stands. **NEVER WORK UNDER AN UNSUPPORTED VEHICLE.** Remove the front tires.
2. Working from the driver side, locate the two holes in the side of the frame as shown in photo below. These two holes will need to be enlarged to allow a $\frac{3}{4}$ " socket into the frame to tighten the bolts for the new bracket. Place the socket against the frame at the hole and draw a line around it for a template. Using a die grinder with a carbide bit, enlarge the hole using the marks on the frame until the socket fits into the frame. SEE PHOTOS BELOW.

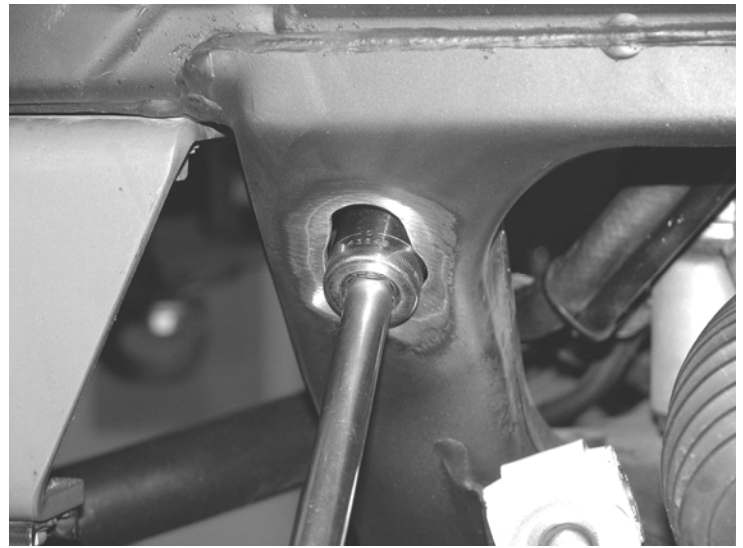

3. Locate FT70077 Driver Frame Bracket and supplied $\frac{1}{2}$ " x 1 $\frac{1}{4}$ " bolts, C-Lock nuts, and washers. Attach the bracket to the inside of the frame and torque to 75 ft. lbs. SEE PHOTO BELOW

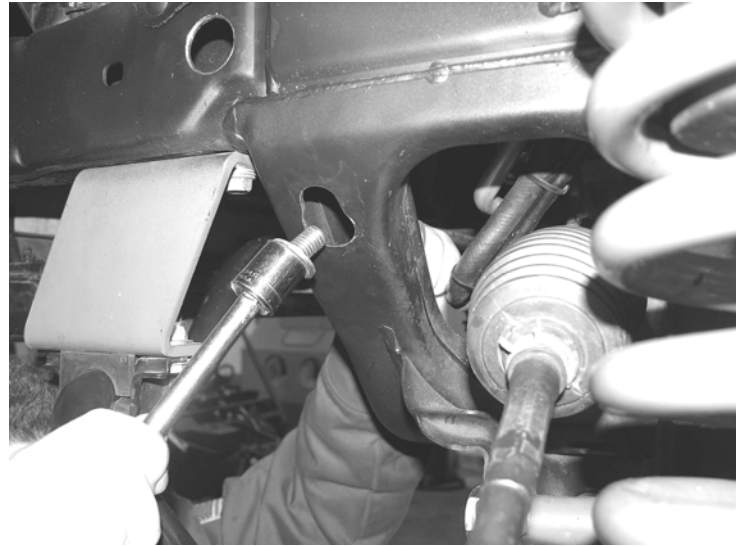

4. Locate FTS7009 Stabilizer and supplied $\frac{1}{2}$ " x $4\frac{1}{4}$ " bolt, $\frac{1}{2}$ " C-Lock nuts, USS and Flat washers. Attach the shaft end of the stabilizer to the frame bracket using the large USS washers on both sides of the shock bushings. Torque to 75 ft. lbs. SEE PHOTO AND DIAGRAM BELOW.



arrows show large USS flat washers on both sides of shock

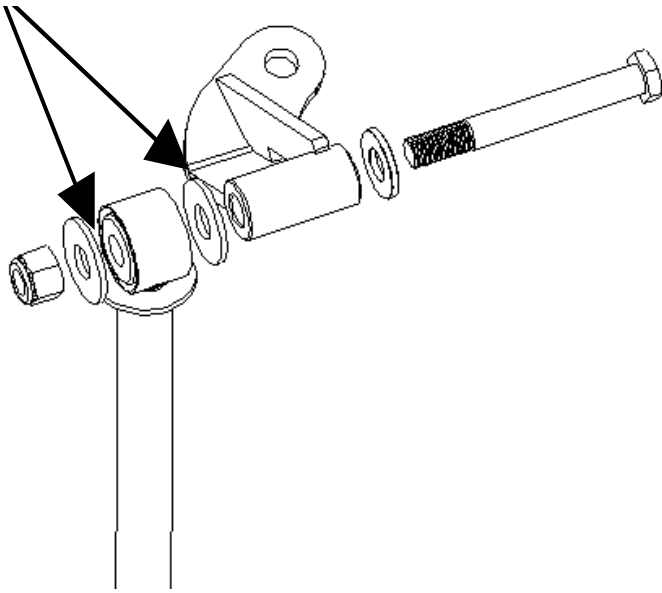

5. Locate FT70076 Tie Rod Bracket and FTS31UBK U-Bolt kit. Place the tie rod bracket onto the tie rod with the flat side of the bracket down and attach with the u-bolt kits. Leave just loose enough for adjustment at this time. SEE PHOTO IN NEXT COLUMN.

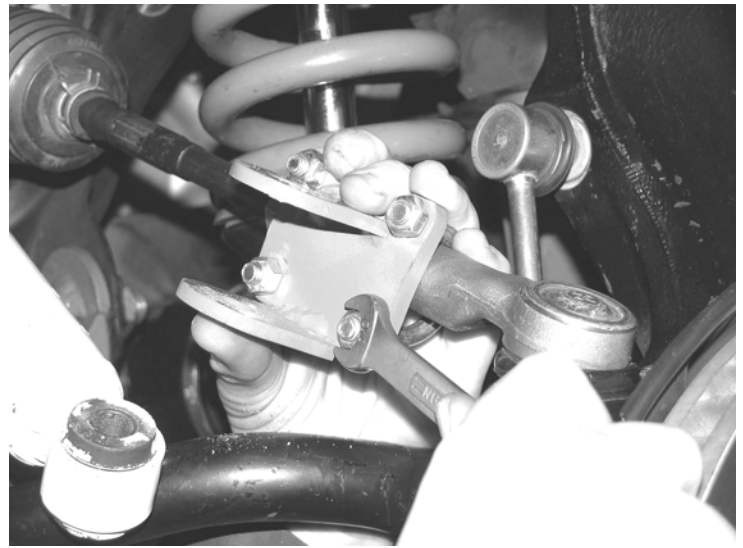

6. Locate the supplied $\frac{1}{2}$ " x $2\frac{3}{4}$ " bolts and hardware. Attach the stabilizer to the tie rod bracket and torque to 75 ft. lbs. Use a tape measure and adjust the tie rod bracket so that there is $5\frac{1}{2}$ " of shaft extended out of the stabilizer (**this is just a starting point measurement**). Torque the $\frac{3}{8}$ " nut on the U-Bolts to 30 ft. lbs. SEE PHOTO BELOW.



7. Repeat steps two through six on passenger side of truck.

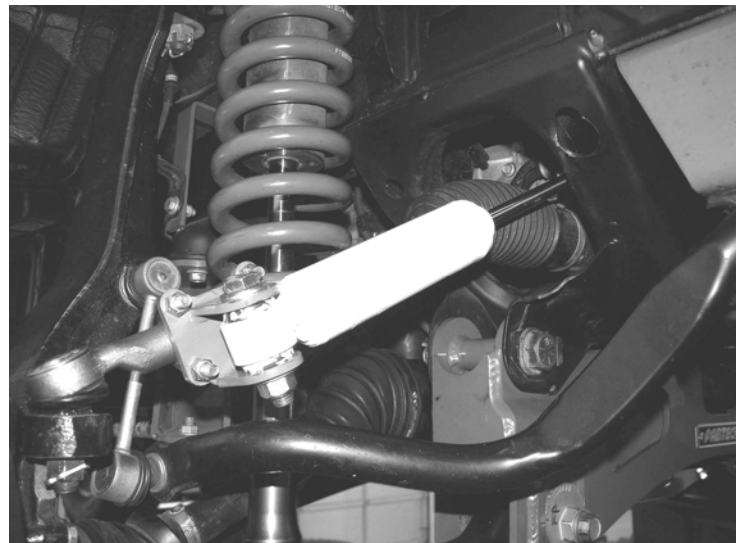

photo of passenger side completed

8. Put the front tires back onto the truck and fully torque the lugs. Factory lug nut torque specification can be found in your owner's manual.
9. Steer the truck fully to the left and right to make sure the steering stabilizers are not bottoming out. Adjust the tie rod

end bracket as needed. Check the clearance of the stabilizers and tie rod brackets for proper clearance.

10. Re-torque all the hardware after 200 miles.

RETORQUE ALL NUTS, BOLTS AND LUGS AFTER 50 MILES AND PERIODICALLY THEREAFTER

For technical assistance call: 909-597-7800

Product Warranty and Warnings-

Fabtech provides a Limited Lifetime Warranty to the original retail purchaser who owns the vehicle, on which the product was originally installed, for defects in workmanship and materials.

The Limited Lifetime Warranty excludes the following Fabtech items; bushings, bump stops, ball joints, tie rod ends, limiting straps, cross shafts, heim joints. These parts are subject to wear and are not considered defective when worn. They are warranted for 60 days from the date of purchase for defects in workmanship.

Take apart shocks are considered a serviceable shock with a one year warranty on leakage only. Service seal kits are available separately for future maintenance. All other shocks are covered under our Limited Lifetime Warranty.

Fabtech does not warrant any product for finish, alterations, modifications and/or installation contrary to Fabtech's instructions. Alterations to the finish of the parts including but not limited to painting, powdercoating, plating and/or welding will void all warranties. Some finish damage may occur to parts during shipping which is considered normal and is not covered under warranty.

Fabtech products are not designed nor intended to be installed on vehicles used in race applications or for racing purposes or for similar activities. (A "RACE" is defined as any contest between two or more vehicles, or any contest of one or more vehicle against the clock, whether or not such contest is for a prize). This warranty does not include coverage for police or taxi vehicles, race vehicles, or vehicles used for government or commercial purposes. Also excluded from this warranty are sales outside of the United States of America.

Installation of most suspension products will raise the center of gravity of the vehicle and will cause the vehicle to handle differently than stock. It may increase the vehicle's susceptibility to a rollover, on road and off road, at all speeds. Extreme care should be taken to operate the vehicle safely at all times to prevent rollover or loss of control resulting in serious injury or death. Fabtech front end Desert Guards may impair the deployment or operation of vehicles equipped with supplemental restraining systems/air bag systems and should not be installed if the vehicle is equipped as so.

Fabtech makes every effort to ensure suspension product compatibility with all vehicles listed in the catalog, but due to unknown auto manufacturers production changes and/or inconsistencies by the auto manufacturer, Fabtech cannot be responsible for 100% compatibility, including the fitment of tire and wheel sizes listed. The Tire and Wheel sizes listed in Fabtech's catalog are only a guideline for street driving with noted fender trimming. Fabtech is not responsible for damages to the vehicle's body or tires.

Fabtech's obligation under this warranty is limited to the repair or replacement, at Fabtech option, of the defective product only. All costs of removal, installation or re-installation, freight charges, incidental or consequential damages are expressly excluded from this warranty. Fabtech is not responsible for damages and/or warranty of other vehicle parts related or non related to the installed Fabtech product. This warranty is expressly in lieu of all other warranties expressed or implied. This warranty shall not apply to any product that has been subject to accident, negligence, alteration, abuse or misuse as determined by Fabtech.

Fabtech suspension components must be installed as a complete system including shocks as shown in our current catalog. All warranties will become void if Fabtech parts are combined and/or substituted with other aftermarket suspension products. Combination and/or substitution of other aftermarket suspension parts may cause premature wear and/or product failure resulting in an accident causing injury or death. Fabtech does not warrant products not manufactured by Fabtech.

Installation of Fabtech product may void the vehicles factory warranty; it is the consumer's responsibility to check with their local vehicle's dealer for warranty disposition before the installation of the product.

It is the responsibility of the distributor and/or the retailer to review all warranties and warnings of Fabtech products with the consumer prior to purchase.

Fabtech reserves the right to supercede, discontinue, change the design, finish, part number and, or application of parts when deemed necessary without written notice. Fabtech is not responsible for misprints or typographical errors within the catalog or price sheet.