



Fabtech Performance Suspensions

4331 Eucalyptus Ave. Chino, CA. USA 91710

Tech Line: 909-597-7800 Fax: 909-597-7185 Web: www.fabtechmotorsports.com

INSTALLATION INSTRUCTIONS

FTS94002BK 1997-2005 JEEP WRANGLER TJ HIGH CLEARENCE TRANSFER CASE SKID PLATE

Parts List:

Qty	Part #	Description
1	FT50043BK	TC Skid Plate
2	FT50016	Motor Mount
4	FT1024	Bushing 6cyl. (BLACK BUSHING)
4	FT1035	Bushing 4cyl. (RED BUSHING)
2	FT90009	Sleeve
6	50133001081	1/2"-13 x 3" Bolt Gr8
6	50000005052	1/2" SAE Flat Washer
6	50000005252	1/2" Split Lock Washer
4	31000005152	5/16" USS Washer
2	43141251052	7/16"-14 x 1 1/4" Bolt Gr5
2	43000005052	7/16" SAE Flat Washer
2	43000005252	7/16" Split Lock Washer
2	43140003052	7/16"-14 Nylok Nut
1	FTLOCK	Thread Locking Compound
1	FT94002i	Instruction Sheet

TOOL LIST: (NOT INCLUDED)

- **ASSORTED METRIC AND S.A.E SOCKETS, & WRENCHES**
- **FLOOR JACK OR TRANSMISSION JACK**
- **ENGINE HOIST**
- **TORQUE WRENCH**

BEFORE YOU BEGIN INSTALLATION PLEASE READ THE FOLLOWING:

THIS TRANSFER CASE SKID PLATE KIT IS FOR USE ON FABTECH'S 6" LONG ARM SUSPENSION KIT ONLY.

DO NOT ALTER THE FINISH OF THESE COMPONENTS, EXAMPLE- CHROMING, ZINC PLATING OR PAINTING. CHANGING THE FINISH CAN CAUSE STRUCTURAL FATIGUE OF COMPONENTS.

READ ALL INSTRUCTIONS THOROUGHLY FROM START TO FINISH BEFORE BEGINNING INSTALLATION! IF THESE INSTRUCTIONS ARE NOT PROPERLY FOLLOWED, SEVERE FRAME, DRIVELINE AND / OR SUSPENSION DAMAGE MAY RESULT.

CHECK ALL PARTS INCLUDED IN THIS KIT TO THE PARTS LIST ABOVE BEFORE BEGINNING INSTALLATION OF THIS KIT. IF ANY PIECES/PARTS ARE MISSING, CONTACT FABTECH AT 909-597-7800.

BEGIN INSTALLATION:

1. Disconnect the negative terminal on the battery. With the Jeep on level ground set the parking brake. **Disconnect the negative terminal of the battery!!**
2. Using a transmission jack or floor jack support the transmission. Locate the four nuts attaching the transmission mount to the crossmember. Remove the nuts and save.
3. Locate the six outer bolts connecting the crossmember to the frame. Remove the bolts and discard. Remove the crossmember. On automatic transmission models you will need to remove the factory mount from the crossmember and save along with the hardware. Discard factory crossmember.
4. Locate the 4wd shift linkage on the driver side of the transfer case. The shift linkage **MUST** be in the stock location for installation of the skid plate. If you have already installed the Fabtech 4wd linkage drop bracket supplied with 6" long arm kit it will need to be removed and the linkage put back to the stock position. SEE PHOTO BELOW.



View from front of truck looking back.

5. Using the floor jack or transmission jack that is supporting the transmission, raise the transmission approx. 3". Locate the Crossmember FT50043 (on automatic transmission models reattach the previously removed mount from the factory crossmember to the new Fabtech crossmember using the factory hardware) and attach the crossmember to the frame using the supplied ½" x 3" bolts along with one split lock washer and one flat washer on each bolt, torque to 90 ft lbs. When installing the crossmember, the four studs on the transmission mount may not line up with the holes in the crossmember until the new motor mounts are installed. **DO NOT ALLOW THE STUDS TO REST ON THE CROSSMEMBER AS YOU MAY DAMAGE THE THREADS. SEE PHOTO NEXT PAGE.**



6. Remove the four bolts attaching the fan shroud to the radiator and save. Leave the fan shroud in place.
7. Using an engine hoist, carefully attach the hoist to the engine and support the motor. Working from both sides of the truck, locate the factory motor mounts. Remove the two bolts attaching the motor mounts to the frame. Save the outer bolt and discard the inner bolt. Locate the center bolt attaching the motor to the motor mount and remove. Using the engine hoist carefully, lift the motor 1". Remove the factory motor mounts and discard.
8. Locate the new supplied FT50016 motor mounts, and press two bushings and one sleeve into each mount. **THE RED BUSHINGS (FT1035) WILL BE USED ON 4CYL MODLES AND THE BLACK BUSHINGS (FT1024) WILL BE USED ON 6CYL MODLES.** Install the new motor mounts into the Jeep in the original location using the original outer bolt and the supplied 7/16" x 1 1/4" bolt, split lock washer, flat washer, and nut along with the supplied thread locking compound on all the threads. Torque bolts to 55 ft lbs. See Photo Below.



Pass. Side Motor Mount Shown

9. Align the motor to new motor mount and reattach using the factory bolts. Torque to 70 ft lbs. Remove the engine hoist from motor.
10. Align the four transmission mounting studs to the new crossmember and attach using the original nuts along with the supplied 5/16" USS washers. Torque to 30 ft lbs. NOTE: you may need to push forward on the transmission to align the four transmission mounting studs to the crossmember.
11. Locate the four mounting holes in the fan shroud. Using a die grinder you will need to slot the four holes up and down approx. 1". Reattach the fan shroud using the original hardware. Check for proper clearance between fan and shroud. Adjust as needed.
12. Remove the rear drive shaft from the Jeep. You will need to disassemble the C.V. joint in the drive shaft and clearance the following dark shaded areas with a grinding wheel. USE CARE TO NOT GRIND COMPLETELY THROUGH THE DRIVE SHAFT MATERIAL, ONLY REMOVE APPRXOMATLY 1/8" OF MATERIAL

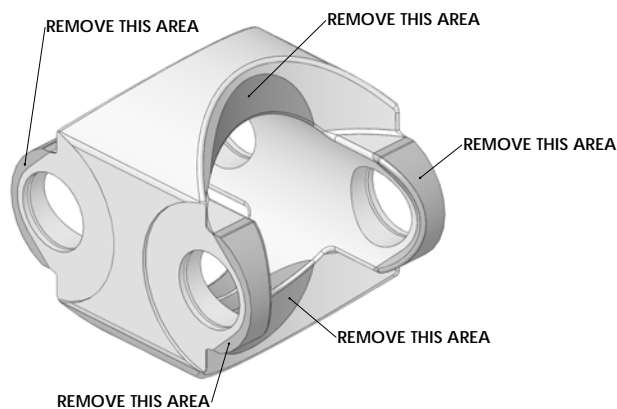
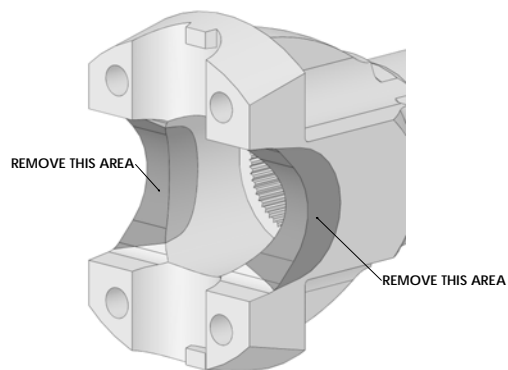
[illegible]

RETORQUE ALL NUTS, BOLTS AND LUGS AFTER 50 MILES AND PERIODICALLY THEREAFTER.

For technical assistance call: 909-597-7800

Product Warranty and Warnings-

Fabtech provides a Limited Lifetime Warranty to the original retail purchaser who owns the vehicle, on which the product was originally installed, for defects in workmanship and materials.

The Limited Lifetime Warranty excludes the following Fabtech items; bushings, bump stops, ball joints, tie rod ends, limiting straps, cross shafts, heim joints. These parts are subject to wear and are not considered defective when worn. They are warranted for 60 days from the date of purchase for defects in workmanship.

Take apart shocks are considered a serviceable shock with a one year warranty on leakage only. Service seal kits are available separately for future maintenance. All other shocks are covered under our Limited Lifetime Warranty.

Fabtech does not warrant any product for finish, alterations, modifications and/or installation contrary to Fabtech's instructions. Alterations to the finish of the parts including but not limited to painting, powdercoating, plating and/or welding will void all warranties. Some finish damage may occur to parts during shipping which is considered normal and is not covered under warranty.

Fabtech products are not designed nor intended to be installed on vehicles used in race applications or for racing purposes or for similar activities. (A "RACE" is defined as any contest between two or more vehicles, or any contest of one or more vehicle against the clock, whether or not such contest is for a prize). This warranty does not include coverage for police or taxi vehicles, race vehicles, or vehicles used for government or commercial purposes. Also excluded from this warranty are sales outside of the United States of America.

Installation of most suspension products will raise the center of gravity of the vehicle and will cause the vehicle to handle differently than stock. It may increase the vehicle's susceptibility to a rollover, on road and off road, at all speeds. Extreme care should be taken to operate the vehicle safely at all times to prevent rollover or loss of control resulting in serious injury or death. Fabtech front end Desert Guards may impair the deployment or operation of vehicles equipped with supplemental restraining systems/air bag systems and should not be installed if the vehicle is equipped as so.

Fabtech makes every effort to ensure suspension product compatibility with all vehicles listed in the catalog, but due to unknown auto manufacturers production changes and/or inconsistencies by the auto manufacturer, Fabtech cannot be responsible for 100% compatibility, including the fitment of tire and wheel sizes listed. The Tire and Wheel sizes listed in Fabtech's catalog are only a guideline for street driving with noted fender trimming. Fabtech is not responsible for damages to the vehicle's body or tires.

Fabtech's obligation under this warranty is limited to the repair or replacement, at Fabtech option, of the defective product only. All costs of removal, installation or re-installation, freight charges, incidental or consequential damages are expressly excluded from this warranty. Fabtech is not responsible for damages and/or warranty of other vehicle parts related or non related to the installed Fabtech product. This warranty is expressly in lieu of all other warranties expressed or implied. This warranty shall not apply to any product that has been subject to accident, negligence, alteration, abuse or misuse as determined by Fabtech.

Fabtech suspension components must be installed as a complete system including shocks as shown in our current catalog. All warranties will become void if Fabtech parts are combined and/or substituted with other aftermarket suspension products. Combination and/or substitution of other aftermarket suspension parts may cause premature wear and/or product failure resulting in an accident causing injury or death. Fabtech does not warrant products not manufactured by Fabtech.

Installation of Fabtech product may void the vehicles factory warranty; it is the consumer's responsibility to check with their local vehicle's dealer for warranty disposition before the installation of the product.

It is the responsibility of the distributor and/or the retailer to review all warranties and warnings of Fabtech products with the consumer prior to purchase.

Fabtech reserves the right to supercede, discontinue, change the design, finish, part number and, or application of parts when deemed necessary without written notice. Fabtech is not responsible for misprints or typographical errors within the catalog or price sheet.