



**4331 EUCALYPTUS AVE. ~~ CHINO, CA 91710**  
**909-597-7800 Fax 909-597-7185**  
**FTS94054**  
**Front Track Bar Drop For 4" Lift**

**PARTS LIST:**

	FTS94054	TJ Frt. Trac Bar Brkt 4"
Qua	Part #	Description
1	FT50134	Trac Bar Bracket
1	FT95010	Frame Sleeve
1	50131751081	1/2"-13 x 1 3/4" Bolt
1	50130004152	1/2"-13 C-Lock Nut
1	50000005081	1/2" SAE Flat Washer
1	56122251081	9/16"-12 x 2 1/4" Bolt
1	56120003052	9/16"-12 C-Lock Nut
2	56000005081	9/16" SAE Flat Washer
1	12002007000	Cotter Pin
2	FT94054i	Instruction Sheet

**TOOL LIST:**

**Assorted Metric & Standard Wrenches**  
**Drill with assorted drill bits up to 3/4"**  
**Torque Wrench**

**WARNING**

**DO NOT ALTER THE FINISH OF THESE COMPONENTS, EXAMPLE- CHROMING, ZINC PLATING OR PAINTING. CHANGING THE FINISH CAN CAUSE STRUCTURAL FATIGUE OF COMPONENTS.**

**VEHICLES THAT WILL RECEIVE OVERSIZED TIRES SHOULD CHECK BALL JOINTS, TIE RODS ENDS AND DRAG LINKS EVERY 2500-5000 MILES FOR WEAR AND REPLACE AS NEEDED**

**THIS KIT IS DESIGNED TO BE INSTALL ON A JEEP WITH STOCK AXELS & STOCK TRANSFER CASE & STOCK SUSPENSION**

**READ ALL INSTRUCTIONS THOROUGHLY FROM START TO FINISH BEFORE BEGINNING INSTALLATION! IF THESE INSTRUCTIONS ARE NOT PROPERLY FOLLOWED, SEVERE FRAME, DRIVELINE AND / OR SUSPENSION DAMAGE MAY RESULT.**

**THIS SUSPENSION SYSTEM DOES NOT REQUIRE WELDING FOR INSTALLATION. DO NOT WELD ANY OF THESE COMPONENTS.**

**CHECK ALL PARTS INCLUDED IN THIS KIT TO THE PARTS LIST ABOVE BEFORE BEGINNING INSTALLATION OF THE KIT. IF ANY PIECES ARE MISSING, CONTACT FABTECH AT 909-597-7800**

### **INSTALLATION INSTRUCTION -**

1. Disconnect the negative terminal on the battery. With the Jeep on level ground set the emergency brake and block the rear tires. Jack up the front end of the truck and support the frame rails just behind the front bumper with jack stands. **NEVER WORK UNDER AN UNSUPPORTED VEHICLE!** Remove the front tires. Support the front axle with a floor jack just enough so that axle does not hang freely
2. Remove the front track bar from the frame mount and save along with the hardware.
3. Using a drill with a 3/4" drill bit, drill the factory upper trac bar mount hole out. Locate insert FT95010 and insert into the factory mounting hole from the topside. Locate FT50134 Trac Bar Drop bracket and place against the frame as shown below. Insert the supplied 9/16" bolt from the top of the factory trac bar mount down into the new drop bracket and follow with another flat washer and C-Lock nut. With the new drop bracket flush to the factory mount, torque to 95 lbs. Using a drill with a 1/2" drill bit, drill the second hole on the drop bracket out through the frame mount. Using the supplied 1/2" x 2" bolt nut and washers secure it to the frame (use care to put a 1/2" washer on both the bolt side and nut when installing. Torque both bolts to 75 ft. lbs. SEE DRAWING BELOW.

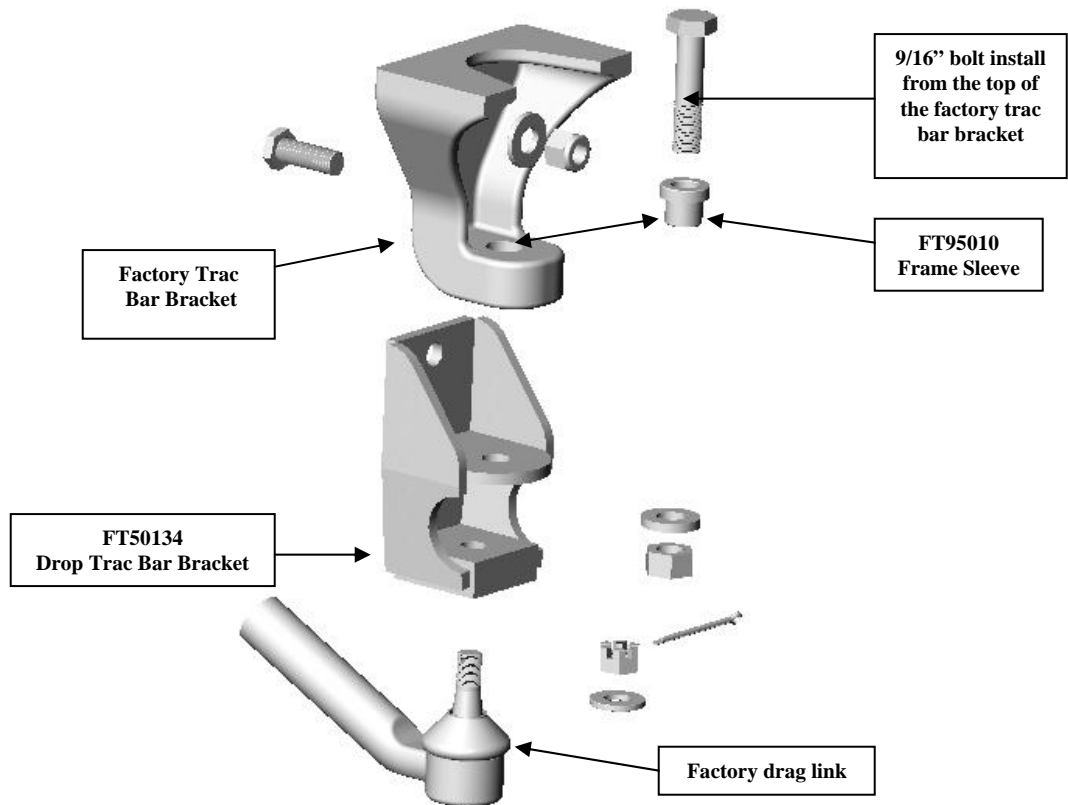

**Check fit front trac bar bracket before drilling the hole, if bracket does not fit contact Fabtech tech line 887-432-2832**

4. Reattach factory trac bar to the new drop bracket with the factory hardware torque to 55 ft. lbs. Insert the new supplied cotter pin through the factory trac bar.
5. Install front tires and wheels. Torque lug nuts to wheel manufacturer's specifications.
6. Check front-end alignment and set to factory specifications.

## **RETORQUE ALL NUTS, BOLTS AND LUGS AFTER 50 MILES AND PERIODICALLY THEREAFTER.**

For technical assistance call: 909-597-7800

### **Product Warranty and Warnings-**

Fabtech provides a Limited Lifetime Warranty to the original retail purchaser who owns the vehicle, on which the product was originally installed, for defects in workmanship and materials.

The Limited Lifetime Warranty excludes the following Fabtech items; bushings, bump stops, ball joints, tie rod ends, limiting straps, cross shafts, heim joints. These parts are subject to wear and are not considered defective when worn. They are warranted for 60 days from the date of purchase for defects in workmanship.

Take apart shocks are considered a serviceable shock with a one year warranty on leakage only. Service seal kits are available separately for future maintenance. All other shocks are covered under our Limited Lifetime Warranty.

Fabtech does not warrant any product for finish, alterations, modifications and/or installation contrary to Fabtech's instructions. Alterations to the finish of the parts including but not limited to painting, powdercoating, plating and/or welding will void all warranties. Some finish damage may occur to parts during shipping which is considered normal and is not covered under warranty.

Fabtech products are not designed nor intended to be installed on vehicles used in race applications or for racing purposes or for similar activities. (A "RACE" is defined as any contest between two or more vehicles, or any contest of one or more vehicle against the clock, whether or not such contest is for a prize). This warranty does not include coverage for police or taxi vehicles, race vehicles, or vehicles used for government or commercial purposes. Also excluded from this warranty are sales outside of the United States of America.

Installation of most suspension products will raise the center of gravity of the vehicle and will cause the vehicle to handle differently than stock. It may increase the vehicle's susceptibility to a rollover, on road and off road, at all speeds. Extreme care should be taken to operate the vehicle safely at all times to prevent rollover or loss of control resulting in serious injury or death. Fabtech front end Desert Guards may impair the deployment or operation of vehicles equipped with supplemental restraining systems/air bag systems and should not be installed if the vehicle is equipped as so.

Fabtech makes every effort to ensure suspension product compatibility with all vehicles listed in the catalog, but due to unknown auto manufacturers production changes and/or inconsistencies by the auto manufacturer, Fabtech cannot be responsible for 100% compatibility, including the fitment of tire and wheel sizes listed. The Tire and Wheel sizes listed in Fabtech's catalog are only a guideline for street driving with noted fender trimming. Fabtech is not responsible for damages to the vehicle's body or tires.

Fabtech's obligation under this warranty is limited to the repair or replacement, at Fabtech option, of the defective product only. All costs of removal, installation or re-installation, freight charges, incidental or consequential damages are expressly excluded from this warranty. Fabtech is not responsible for damages and/or warranty of other vehicle parts related or non related to the installed Fabtech product. This warranty is expressly in lieu of all other warranties expressed or implied. This warranty shall not apply to any product that has been subject to accident, negligence, alteration, abuse or misuse as determined by Fabtech.

Fabtech suspension components must be installed as a complete system including shocks as shown in our current catalog. All warranties will become void if Fabtech parts are combined and/or substituted with other aftermarket suspension products. Combination and/or substitution of other aftermarket suspension parts may cause premature wear and/or product failure resulting in an accident causing injury or death. Fabtech does not warrant products not manufactured by Fabtech.

Installation of Fabtech product may void the vehicles factory warranty; it is the consumer's responsibility to check with their local vehicle's dealer for warranty disposition before the installation of the product.

It is the responsibility of the distributor and/or the retailer to review all warranties and warnings of Fabtech products with the consumer prior to purchase.

Fabtech reserves the right to supercede, discontinue, change the design, finish, part number and, or application of parts when deemed necessary without written notice. Fabtech is not responsible for misprints or typographical errors within the catalog or price sheet.