



[www.fabtechmotorsports.com](http://www.fabtechmotorsports.com)

**4331 EUCALYPTUS AVE. CHINO, CA. 91710**  
**PHONE 909-597-7800 FAX 909-597-7185**

**1987 - 1995 Jeep YJ**  
**FTT94010BK**  
**Jeep YJ Rocker Guards**

**PARTS LIST:**

Qua	Part #	Description
1	FT50236BK	Driver Rocker Guard
1	FT50237BK	Pass. Rocker Guard
1	FT50245	Hardware Kit
1	FT50246	Rivet Tool
1	FTREGCAR D	Registration Form
1	FTAS12	Fabtech Sticker
2	FTT94010i	Instruction Sheet

**HARDWARE LIST:**

Qua	Description
12	3/8"-16 x 1 1/2" Counter Sunk Stainless Allen
12	3/8"-16 C-Lock Nut
12	3/8" USS Flat Washer
4	3/8"-16 Threaded Insert <b>(ALS4-616-312) open end</b>
2	3/8" SAE Flat Washers
2	3/8"-16 x 2" Hex Head Bolt
2	1/2"-13 <b>non</b> -locking plain nut

**Tool List: (Not Included)**

- **Floor Jack**
- **Assorted Metric and S.A.E Sockets & Allen Wrenches**
- **Drill with Assorted drill bits**
- **Die Grinder w/ cut-off wheel**

**READ ALL INSTRUCTIONS THOROUGHLY FROM START TO FINISH BEFORE BEGINNING INSTALLATION!**

**CHECK ALL PARTS INCLUDED IN THIS KIT TO THE PARTS LIST ABOVE BEFORE BEGINNING INSTALLATION OF THIS KIT. IF ANY PIECES ARE MISSING, CONTACT FABTECH AT 909-597-7800.**

**THEIR WILL BE EXTRA HARDWARE AFTER THE INSTALLATION OF THIS KIT. THIS HARDWARE KIT IS USED IN MULTIPLE APPLICATIONS.**

## **INSTRUCTIONS:**

1. Disconnect the negative terminal on the battery. Place the Jeep on a level working area. Working from both sides of the vehicle, loosen all of the body mounts. (**loosen only, do not remove at ANY time**).
2. Working from the driver's side, remove all of the body mount bolts from this side. Use a floor jack and carefully raise the body just enough to remove the two upper body mount bushings that will hold the Rocker Guards. If your vehicle has factory mounted fender flare cab extensions, they will need to be removed at this time. SEE PHOTO BELOW.



3. Locate FT50236BK Driver side guard and install it at the two body mount locations (**guard mounts above washer and bushing**). Use care when placing the guard against the body to keep from damaging any of the areas that will not be covered by the rocker guard. Locate the guard against the body of the Jeep to the final mounting area. Lower the body back down onto the frame and mark each mounting hole in the guard to the body. (**Make sure that the guard is held tight against the body of the Jeep**). Once all the holes are marked, carefully raise the body just enough to remove the guard so the holes can be drilled.
4. Using a drill with a 3/8" bit, drill out all of the previously marked areas. **The second hole from the front and the second hole from the rear will require a threaded nut insert. Drill ONLY these two holes EXACTLY to 17/32"**. Make sure that there is no wiring or interior parts behind the body where you are drilling. SEE PHOTO IN NEXT COLUMN.



5. Locate FT50246 Insert Installation Tool, the supplied threaded inserts, 3/8"-16 x 2" bolt, 3/8" flat washers, and 1/2" nut. Take the bolt and place a 3/8" washer on it first, follow with the 1/2" nut, the installation tool, then another 3/8" washer, then thread on the insert. Finger tighten the bolt and insert. Place the insert into the previously drilled hole. Use an impact to tighten the bolt to set the insert into the body. It may be necessary to angle the tool slightly to help the insert grip the body of the Jeep. Remove the bolt and the tool. SEE PHOTO BELOW AND DIAGRAM AND PHOTOS ON NEXT PAGE.

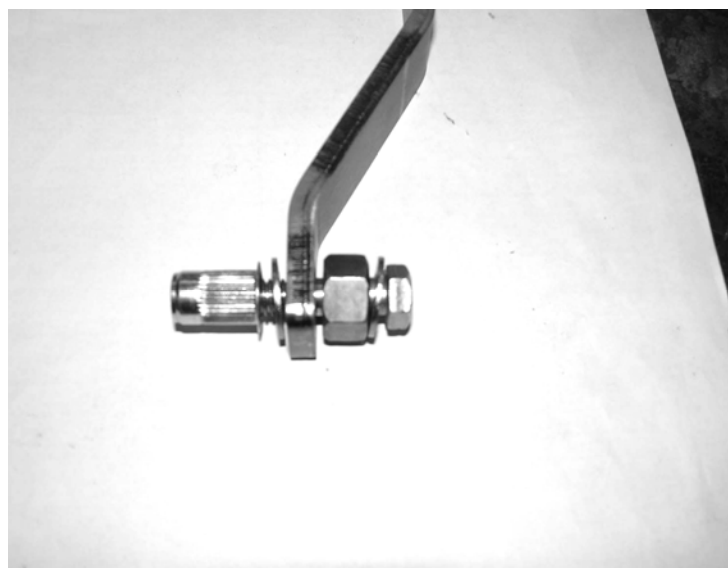

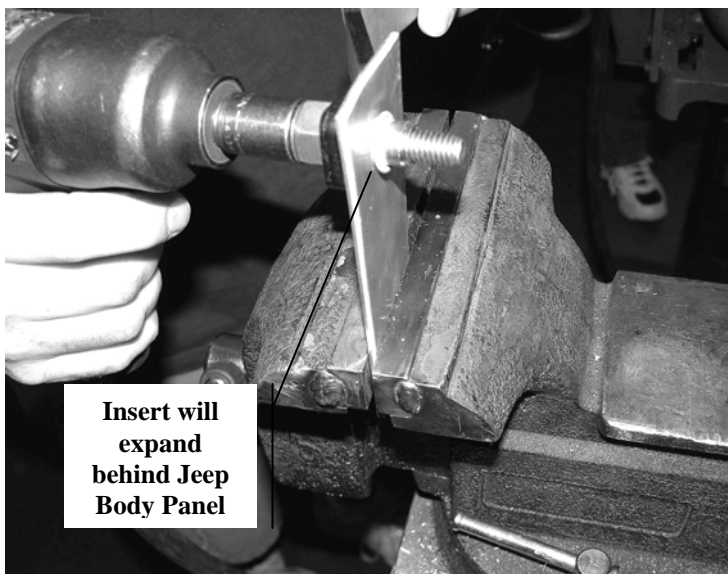
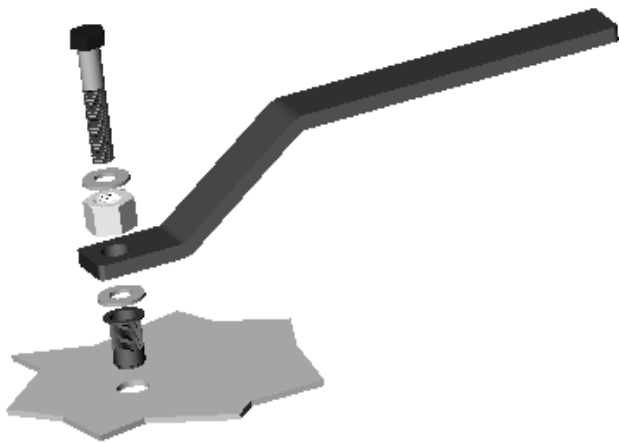

6. Clean all of the metal shavings from drilling off of the body. Use paint or clear silicone to cover any raw or exposed metal where the holes were drilled to prevent any rusting. Re-install the Rocker Guard on the body mounts and against the body of the jeep. Make the two guard mounting body mount bolts the same tightness as the others. Locate the 3/8" hardware to attach the guard to the body. Torque the 3/8" hardware to 25 ft. lbs. and lower the body back down onto the frame. SEE PHOTO BELOW.



7. If your Jeep has the fender flares that run along the body, you will need to trim the bottom of the flare for proper clearance of the flare to the rocker guard. Mark and cut the flare as desired. SEE PHOTOS ON NEXT PAGE.



8. Repeat steps two through seven on the passenger side of the Jeep.
9. Torque all of the body mounts to 75lbs.

**RETORQUE ALL NUTS, BOLTS AND LUGS AFTER 50 MILES AND PERIODICALLY THEREAFTER.**  
For technical assistance call: 909-597-7800

## Product Warranty and Warnings-

Fabtech provides a Limited Lifetime Warranty to the original retail purchaser who owns the vehicle, on which the product was originally installed, for defects in workmanship and materials.

The Limited Lifetime Warranty excludes the following Fabtech items; bushings, bump stops, ball joints, tie rod ends, limiting straps, cross shafts, heim joints. These parts are subject to wear and are not considered defective when worn. They are warranted for 60 days from the date of purchase for defects in workmanship.

Take apart shocks are considered a serviceable shock with a one year warranty on leakage only. Service seal kits are available separately for future maintenance. All other shocks are covered under our Limited Lifetime Warranty.

Fabtech does not warrant any product for finish, alterations, modifications and/or installation contrary to Fabtech's instructions. Alterations to the finish of the parts including but not limited to painting, powdercoating, plating and/or welding will void all warranties. Some finish damage may occur to parts during shipping which is considered normal and is not covered under warranty.

Fabtech products are not designed nor intended to be installed on vehicles used in race applications or for racing purposes or for similar activities. (A "RACE" is defined as any contest between two or more vehicles, or any contest of one or more vehicle against the clock, whether or not such contest is for a prize). This warranty does not include coverage for police or taxi vehicles, race vehicles, or vehicles used for government or commercial purposes. Also excluded from this warranty are sales outside of the United States of America.

Installation of most suspension products will raise the center of gravity of the vehicle and will cause the vehicle to handle differently than stock. It may increase the vehicle's susceptibility to a rollover, on road and off road, at all speeds. Extreme care should be taken to operate the vehicle safely at all times to prevent rollover or loss of control resulting in serious injury or death. Fabtech front end Desert Guards may impair the deployment or operation of vehicles equipped with supplemental restraining systems/air bag systems and should not be installed if the vehicle is equipped as so.

Fabtech makes every effort to ensure suspension product compatibility with all vehicles listed in the catalog, but due to unknown auto manufacturers production changes and/or inconsistencies by the auto manufacturer, Fabtech cannot be responsible for 100% compatibility, including the fitment of tire and wheel sizes listed. The Tire and Wheel sizes listed in Fabtech's catalog are only a guideline for street driving with noted fender trimming. Fabtech is not responsible for damages to the vehicle's body or tires.

Fabtech's obligation under this warranty is limited to the repair or replacement, at Fabtech option, of the defective product only. All costs of removal, installation or re-installation, freight charges, incidental or consequential damages are expressly excluded from this warranty. Fabtech is not responsible for damages and/or warranty of other vehicle parts related or non related to the installed Fabtech product. This warranty is expressly in lieu of all other warranties expressed or implied. This warranty shall not apply to any product that has been subject to accident, negligence, alteration, abuse or misuse as determined by Fabtech.

Fabtech suspension components must be installed as a complete system including shocks as shown in our current catalog. All warranties will become void if Fabtech parts are combined and/or substituted with other aftermarket suspension products. Combination and/or substitution of other aftermarket suspension parts may cause premature wear and/or product failure resulting in an accident causing injury or death. Fabtech does not warrant products not manufactured by Fabtech.

Installation of Fabtech product may void the vehicles factory warranty; it is the consumer's responsibility to check with their local vehicle's dealer for warranty disposition before the installation of the product.

It is the responsibility of the distributor and/or the retailer to review all warranties and warnings of Fabtech products with the consumer prior to purchase.

Fabtech reserves the right to supercede, discontinue, change the design, finish, part number and, or application of parts when deemed necessary without written notice. Fabtech is not responsible for misprints or typographical errors within the catalog or price sheet.