

# FABTECH<sup>®</sup>

## SHOCK SPECIFICATIONS



**FabtechMotorsports.com**

# MOUNTING CODE "EB" EYE RING AND BUSHING

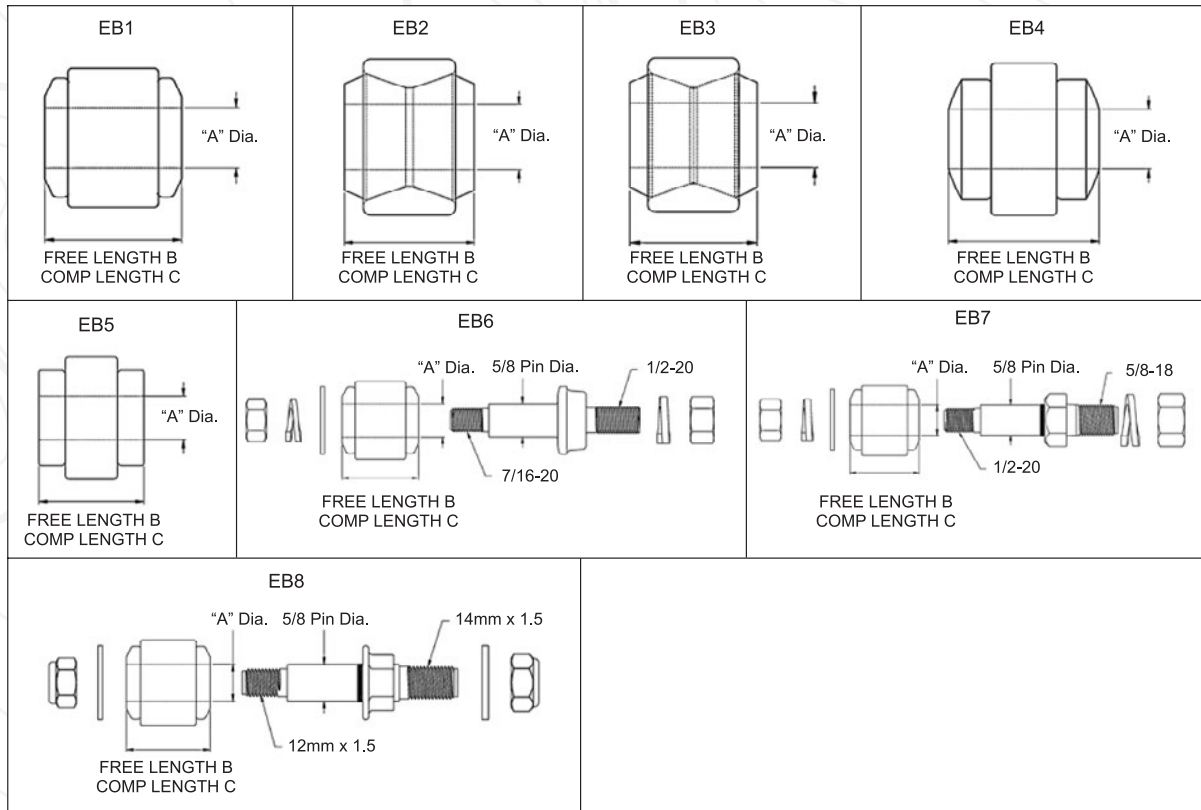

MOUNTING CODE	A DIAMETER	B FREE LENGTH	C COMP. LENGTH	VEHICLE MOUNTING PIN DIAMETER
EB1	5/8	1.44	1.31	5/8
EB2	3/4	1.75	1.50	3/4
EB3	1.00	1.91	1.75	1.00
EB4	11/16	1.72	1.55	11/16
EB5	5/8	1.51	1.25	5/8
EB6	5/8	1.44	1.31	Mounting pin furnished with shock absorber for 1/2 diameter vehicle mounting hole.
EB7	5/8	1.44	1.31	Mounting pin furnished with shock absorber for 5/8 diameter vehicle mounting hole.
EB8	5/8	1.44	1.31	Mounting pin furnished with shock absorber for 14MM diameter vehicle mounting hole.
EB9	1	1.75	-	1
EB10	1.00	1.00	-	1.00
EB11	3/8	0.83	-	3/8
EB12	10MM	1.18	-	10MM
EB13	12MM	1.03	-	12MM
EB14	15MM	1.41	-	15MM
EB15	15MM	1.76	-	15MM
EB16	16MM	1.5	-	16MM
EB17	18MM	1.18	-	17MM
EB18	19MM	1.65	-	19MM
EB19	20MM	1.75	1.25	20MM
EB20	45/64	1.05	-	45/64
EB21	45/64	1.39	-	45/64
EB22	20MM	1.575	-	20MM
EB23	24	1.654	-	24
EB24	20MM	1.693	-	20MM
EB25	22MM	1.5	-	22MM

# SPECIFICATIONS - SHOCK MOUNT CODES

MOUNT CODE	SLEEVE ID (A)	SLEEVE OAL (B)
LS1	10MM	15/16"
LS2	10MM	1"
LS3	10MM	1-1/4"
LS4	10MM	1-3/8"
LS5	10MM	1-7/16"
LS6	10MM	1-8/16"
LS7	10MM	1-5/8"
LS8	10MM	2"
LS9	10MM	2-1/8"
LS10	10MM	2-3/8"
LS11	10MM	3"
LS12	7/16"	1-1/4"
LS13	7/16"	1-5/16"
LS14	7/16"	1-3/8"
LS15	7/16"	1-7/16"
LS16	7/16"	1-5/8"
LS17	7/16"	1-7/8"
LS18	7/16"	2-1/8"
LS19	7/16"	3-3/16"
LS20	7/16"	3-3/8"
LS21	12MM	1"
LS22	12MM	1-1/8"
LS23	12MM	1-1/4"
LS24	12MM	1-3/8"
LS25	12MM	1-7/16"
LS26	12MM	1-1/2"
LS27	12MM	1-8/16"
LS28	12MM	1-5/8"
LS29	12MM	1-3/4"
LS30	12MM	1-7/8"
LS31	12MM	2"
LS32	12MM	2-1/8"
LS33	12MM	2-5/16"
LS34	12MM	2-7/8"
LS35	1/2"	1-1/4"
LS36	1/2"	1-5/16"
LS37	1/2"	1-3/8"
LS38	1/2"	1-1/2"
LS39	1/2"	1-5/8"
LS40	1/2"	1-11/16"

MOUNT CODE	SLEEVE ID (A)	SLEEVE OAL (B)
LS41	1/2"	2-1/4"
LS42	14MM	1-5/16"
LS43	14MM	1-8/16"
LS44	14MM	1-7/8"
LS45	14MM	2-7/16"
LS46	14MM	3-1/8"
LS47	9/16"	1-5/8"
LS48	9/16"	2-7/16"
LS49	5/8"-16MM	1-3/16"
LS50	5/8"-16MM	1-1/2"
LS51	5/8"-16MM	1-8/16"
LS52	5/8"-16MM	1-11/16"
LS53	5/8"-16MM	2"
LS54	3/4"	1-3/4"
LS55	18MM	1-3/8"
LS56	20MM	1-9/16"
LS57	20MM	2"
LS58	20MM	2-7/16"
LS59	3/4"	3-13/16"
LS60	3/4"	3-3/16"
LS61	5/8"-16MM	4"
LS62	5/8"-16MM	2-9/16"
LS63	1/2"	1/2"
LS64	21MM	1-13/16"
LS65	1"	2"
LS66	3/4"	1-3/8"
LS67	3/4"	1-11/16"
LS68	3/4"	1-7/8"
LS69	3/4"	1-13/16"
LS70	3/4"	2-1/4"
LS71	3/4"	2-3/4"
LS72	7/16"	2"
LS73	7/16"	2-1/2"
LS74	12MM	1-11/16"
LS75	20MM	1-3/4"
LS76	1/2"	2-3/8"
LS77	1/2"	2-7/16"
LS78	9/16"	1-1/2"
LS79	5/8"-16MM	1-3/8"
LS80	5/8"-16MM	1-3/4"

BUSHING & SLEEVE

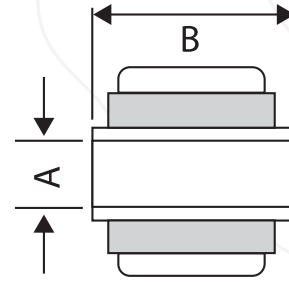

MOUNT CODE	SLEEVE ID (A)	SLEEVE OAL (B)
LS81	5/8"-16MM	1-7/8"
LS82	5/8"-16MM	1-1/2"
LS83	18MM	2"
LS84	12MM	2-3/8"
LS85	5/8"-16MM	1-3/16"
LS86	3/4"	2-5/16"
LS87	5/8"-16MM	3-8/16"
LS88	14MM	2-7/16"
LS89	1"	1-3/4"
LS90	14MM	2-5/8"
LS91	14MM	1-3/4"
LS92	14MM	1-11/16"
LS93	18MM	3-1/4"
LS94	5/8"-16MM	2-3/4"
LS95	20MM	2-3/8"
LS96	1/2"	1-7/8"
LS97	1/2"	2-3/4"
LS98	5/8"-16MM	3"
LS99	5/8"-16MM	3-1/4"
LS100	1-1/8"	4"
LS101	1-1/8"	2-5/8"
LS102	7/8"	2-1/4"
LS103	1/2"	3-3/4"
LB1	1/2"	3/4"

# ***FabtechMotorsports.com***

CONTACT US: (909) 597-7800 | [INFO@FABTECHMOTORSPORTS.COM](mailto:INFO@FABTECHMOTORSPORTS.COM)

FABTECH PREMIUM PARTNERS



**FACTOR 55**



BRO# FTSHOCKSPEC526MFG1